

# Dreame F20

Robot Vacuum and Mop  
User Manual

DREAME



The illustrations in this manual are for reference only. Please refer to the actual product.

**A**  
**A-1**

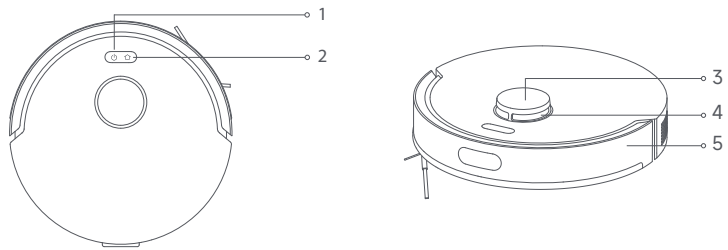

**A-1**

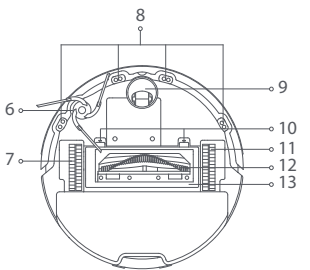

**A-2**

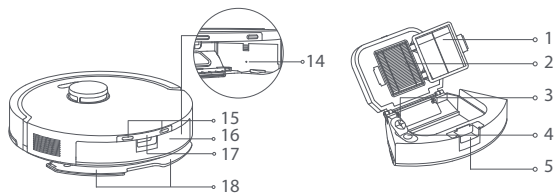

**A-3**

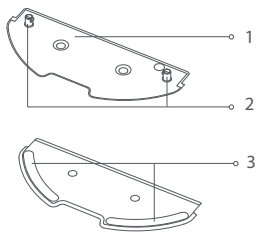

**A-4**

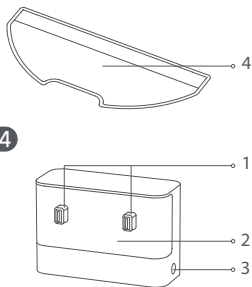

**B**

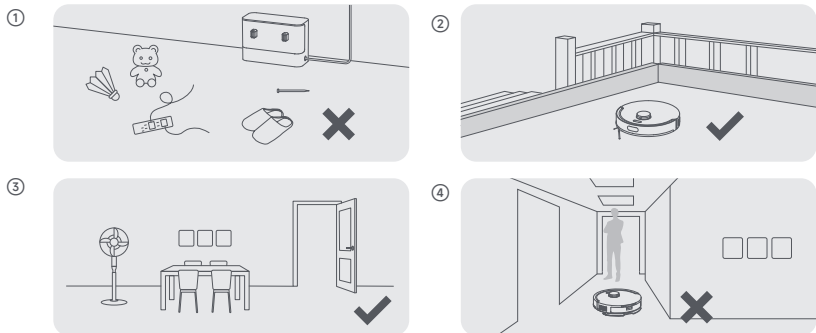

**C**

**C-1**

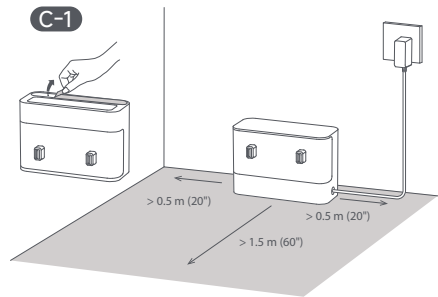

**C-2**

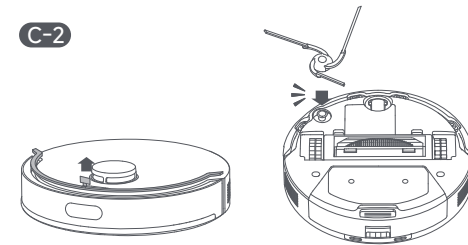

**C-3**

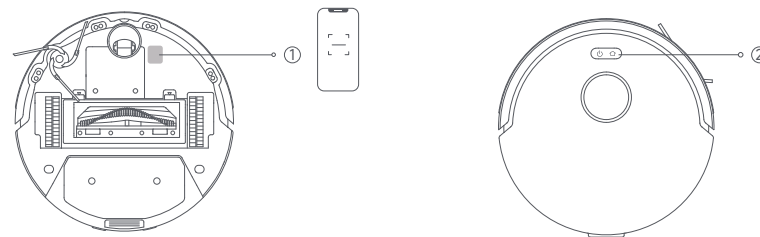

**C-4**

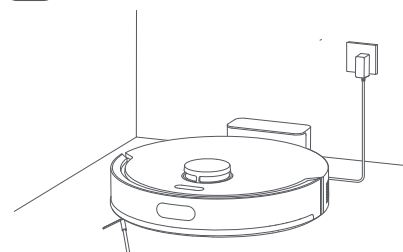

**D**

**D-1**

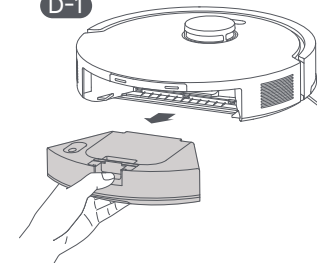

**D-2**

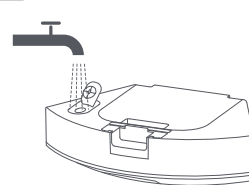

**D-3**

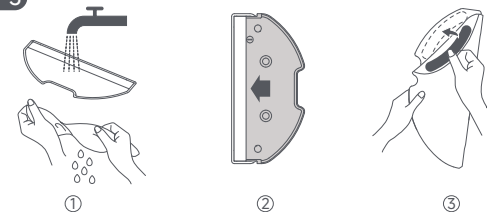

D-4

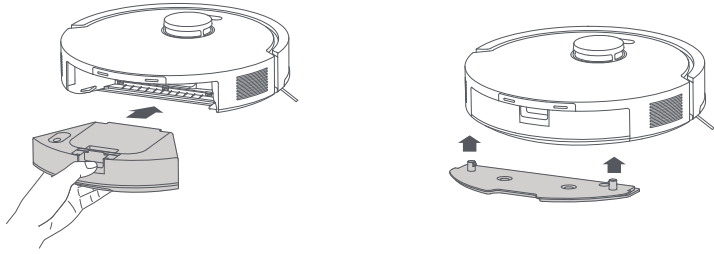

E-4

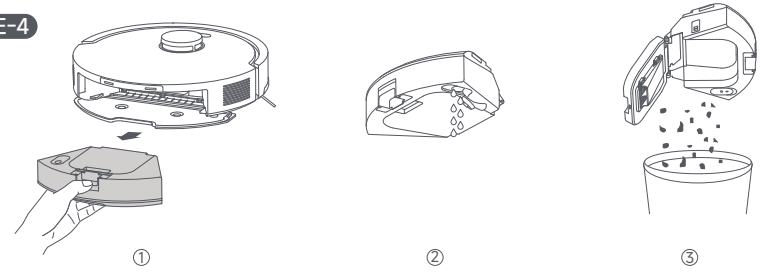

D-5



E-5

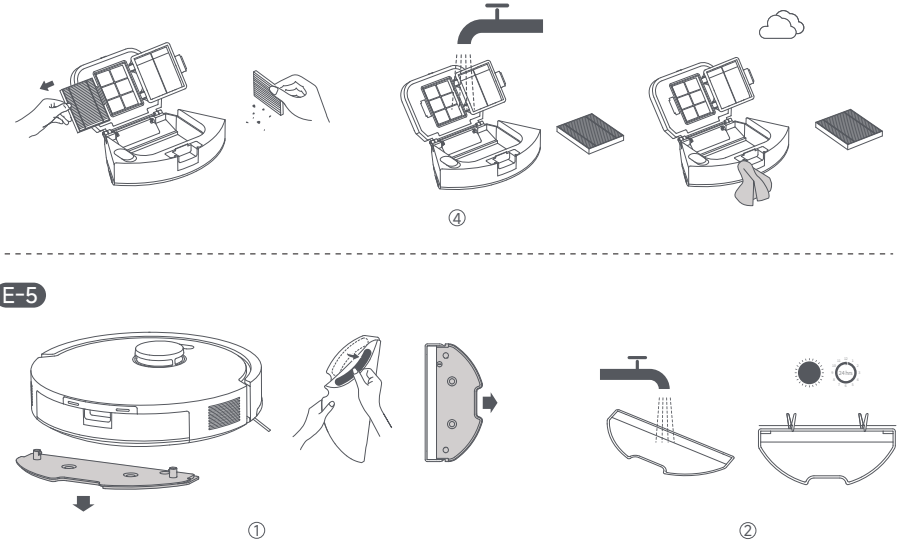

E

E-1

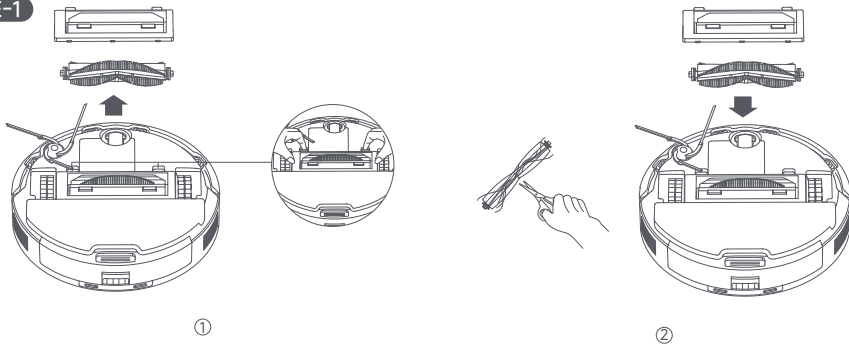

E-6

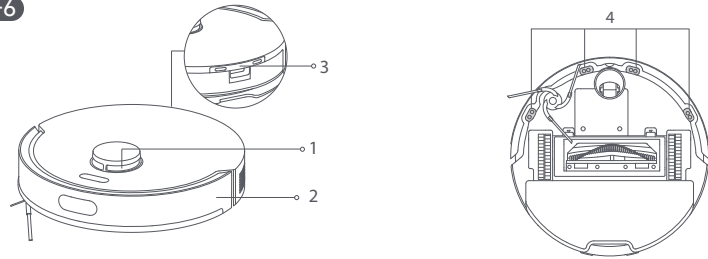

E-2

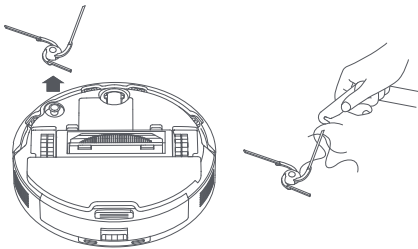

E-3

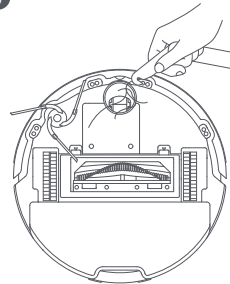

E-7

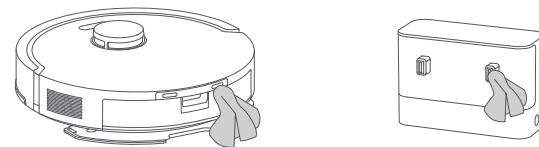

# Contents

<b>EN</b>	User Manual .....	01
<b>TR</b>	Kullanici Kilavuzu .....	15
<b>VI</b>	Hướng dẫn sử dụng .....	29
<b>TH</b>	คู่มือการใช้งาน .....	43
<b>ID</b>	Panduan Pengguna .....	57

## Safety Information

To avoid electric shock, fire or injury caused by improper use of the appliance, please read the user manual carefully before using the appliance and keep it for future reference.

### Usage Restrictions

- This product should not be used by children younger than 8 years old nor persons with physical, sensory, intellectual deficiencies, or limited experience or knowledge without the supervision of a parent or guardian to ensure safe operation and to avoid any risks. Cleaning and maintenance shall not be performed by children without supervision.
- Children shall not play with this product. Ensure children and pets are kept at a safe distance from the robot while it is operating.
- This product is for floor cleaning in a home environment only. Do not use it outdoors, on non-floor surfaces, or in a commercial or industrial setting.
- If the adaptor becomes damaged or broken, stop using it immediately and contact after-sales service.
- Do not use the robot in an area suspended above ground level without a protective barrier.
- Do not place the robot upside down. Do not use the LDS cover, robot cover, or bumper as a handle for the robot.
- Use the robot in environments with an ambient temperature above 0°C and below 40°C. Make sure there is no liquid or sticky substance on the floor.
- Pick up any cables from the floor before using the robot to prevent it from dragging them while cleaning.

## Safety Information

- Remove fragile or small items from the floor to prevent the robot from bumping into and damaging them.
- To prevent damage or harm from dragging, clear any loose objects from the floor, and remove cables or power cords on the cleaning path before operating the appliance.
- Keep hair, fingers, and other body parts away from the suction opening of the robot.
- Keep the brush cleaning tool out of reach of children.
- Do not place children, pets, or any item on top of the robot regardless of whether it is stationary or moving.
- Do not use the robot to clean any burning objects. Do not use the robot to pick up flammable or combustible liquids, corrosive gases, or undiluted acids or solvents.
- Do not vacuum hard or sharp objects. Do not use the appliance to pick up objects such as stones, large pieces of paper or any item that may clog the appliance.
- Make sure the robot is turned off and the charging dock is unplugged before cleaning or performing maintenance.
- Do not use a wet cloth to wipe or any liquid to rinse the robot and charging dock. Washable parts must be dried completely before installing and using them.
- Make sure the robot is turned off when being transported and kept in its original packaging if possible.
- Please use this product in accordance with the instructions in the User Manual. Users are responsible for any loss or damage that arise from improper use of this product.

## Safety Information

### Batteries and Charging

- **WARNING:** Against recharging non-rechargeable batteries.
- Do not use any third-party battery, adaptor, or charging dock. Use only with RCFA0301 supply unit.
- Do not attempt to disassemble, repair, or modify the battery or charging dock on your own.
- Do not place the charging dock near a heat source.
- Do not use a wet cloth or wet hands to wipe or clean the dock's charging contacts.
- Do not improperly dispose of old batteries. Unneeded batteries should be discarded at an appropriate recycling facility.
- If the robot will not be used for an extended period, fully charge it, then turn it off and store in a cool, dry place. Recharge the robot at least once every 3 months to avoid over-discharging the battery.
- This product contains batteries that can only be replaced by qualified technicians or after-sales service.

### Laser Safety Information

- The laser sensor in this product meets the IEC 60825-1:2014/EN 60825-1:2014/A11:2021 Standard for Class 1 laser products. Please avoid direct eye contact with it during use.

CLASS 1 LASER PRODUCT  
CONSUMER LASER PRODUCT  
EN 50689:2021

## Safety Information



For indoor use only



Read operator's manual

Hereby, Dreame Trading (Tianjin) Co., Ltd. declares that the radio equipment type RLF41GA is in compliance with Directive 2014/53/EU. The full text of the EU declaration of conformity is available at the following internet address: <https://global.dreame.tech.com>  
For detailed e-manual, please go to <https://global.dreame.tech.com/pages/user-manuals-and-faqs>

## A Product Overview

### Robot

1. Power/Clean Button
  - Press and hold for 3 seconds to turn on or off
  - Press to start cleaning after the robot is turned on
2. Dock/Spot Cleaning Button 
  - Press to send the robot back to the charging dock
  - Press and hold for 3 seconds to start spot cleaning
- Button Status Indicator
  - Solid White: Cleaning or cleanup completed
  - Blinking Orange: Error
  - Breathing White: Robot is charging when the battery power is not low

### Note:

- Press any button on the robot to pause while the robot is cleaning or returning to charge.
  - Press and hold the power button and the dock button for 3 seconds to reset Wi-Fi.
  - Child Lock can be enabled/disabled through the Dreamehome app.
3. LDS Cover
  4. Laser Distance Sensor (LDS)
  5. Bumper
  6. Side Brush
  7. Main Wheel
  8. Cliff Sensors
  9. Omnidirectional Wheel
  10. Brush Guard Clips
  11. Main Wheel

12. Main Brush
13. Brush Guard
14. Reset Button
  - Press and hold for 3 seconds to restore to factory settings
15. Charging Contacts
16. 2-in-1 Water Tank with Dust Box
17. Return-to-Base Sensor
18. Mop Assembly

### Fig. A-1

### 2-in-1 Water Tank with Dust Box

1. Filter Holder
2. HEPA Filter
3. Water Inlet Lid
4. Water Inlet
5. Release Clip

### Fig. A-2

### Mop Assembly

1. Mop Pad Holder
2. Release Clips
3. Mop Pad Attachment Area
4. Mop Pad

### Fig. A-3

### Charging Dock

1. Charging Contacts
2. Signaling Area
3. Power Port

### Fig. A-4

## B Preparing Your Home

EN

1. Before cleaning, please move away unstable, fragile, valuable or dangerous items, and clean up cables, cloths, toys, hard objects and sharp objects on the ground to avoid being entangled, scratched or knocked over by the robot and causing losses.
2. Before cleaning, place a physical barrier at the edge of the stairs to ensure the secure and smooth operations of the robot.
3. Open the door of the room to be cleaned, and put the furniture in its proper place to leave more space.
4. To prevent the robot from not recognizing areas that need to be cleaned, do not stand in front of the robot, or in a threshold, hallway, or narrow places.

### Note:

- When operating the robot for the first time, follow it around while cleaning to remove any potential obstacles in time.
- Do not vacuum hard objects like stones, steel balls and toy parts, or sharp objects like construction waste, broken glass and nails, otherwise the ground may be scratched.

### Fig. B

## C Before Use

### 1. Place the Charging Dock and Connect to an Electrical Outlet

Peel off the double-sided tape at the bottom of the charging dock. Place the charging dock in a location that is as open as possible with a good Wi-Fi signal. Leave enough space as shown in the figure and remove any objects in the shaded area. Insert the adaptor into the charging dock and plug it into the socket.

#### Note:

- Remove any objects that are closer than 1.5 m from the front and 0.5 m from either side of the charging dock.
- Do not place the charging dock in an area with direct sunlight or where other objects might block the signal, as this may hinder the robot from returning to the charging dock.
- To prevent water stains from wetting wood floors or carpets, placing the charging dock on tile floors or marble floors is recommended.

### 2. Remove the Protections and Install the Side Brush

### 3. Connect with the Dreamehome App

- (1) Press and hold the power button on the robot for 3 seconds to turn it on. Scan the QR code on the robot or search "Dreamehome" in the app store to download and install the app.
- (2) Open the Dreamehome app, tap "Scan QR code to connect", and scan the same QR code on the robot again to add the device. Please follow the

prompts to finish the Wi-Fi connection.

- ① QR code
  - ② Wi-Fi Indicator
- Blinking: To be connected / Connecting
  - On: Connected

#### Note:

- Only 2.4 GHz Wi-Fi is supported.
- To reset Wi-Fi, repeat step (2) and then follow the prompts to finish the Wi-Fi connection.
- To disconnect the device from Wi-Fi network, press and hold the Reset button on the robot for 3 seconds.
- Due to upgrades in the app software, the actual operations may differ from the directions in this manual. Please follow the instructions based on the current app version.

### 4. Charge the Robot

When placing the robot, align the charging contacts of the robot with the charging contacts of the charging dock, and the robot will automatically turn on and start charging.

After the robot is fully charged, the status indicators on the robot and the charging dock will remain lit for 10 minutes and then dim.

**Note:** It is recommended to fully charge the robot before its first use. When the robot cannot be turned on after the battery is depleted, manually connect the robot with the charging dock to charge it.

#### Fig. C-1-Fig. C-4

## D How to Use

### Turn On/Off

Press and hold the power button for 3 seconds to turn on the robot. The power indicator should be illuminated. Place the robot onto the charging dock, the robot should turn on automatically and begin charging. To turn off the robot, move the robot away from the charging dock and press and hold the power button for 3 seconds.

### Fast Mapping

After configuring the network for the first time, follow the instructions in the app to quickly create a map. The robot will start mapping without cleaning. When the robot returns to the charging dock, the mapping process has been completed and the map will be saved automatically.

### Start Cleaning

Press the power button to start cleaning after the robot is turned on. The robot will accurately map out a route, methodically clean along the edges and walls, then finish by cleaning each room in an S-shaped pattern to ensure a thorough job.

**Note:** It is recommended that the robot set out from the charging dock before cleaning. Do not move the charging dock while the robot is cleaning. This ensures that the robot returns to charging dock smoothly.

### Pause/Sleep

When the robot is running, press any button to pause it.

If the robot is paused for more than 10 minutes, it automatically enters sleep mode. All indicators on the robot will turn off. Press any button on the robot, or use the app to wake up the robot.

**Note:** If the robot is paused and placed onto the charging dock, the current cleaning process will end.

### Auto Resume Cleaning

If the battery is too low, the robot will automatically return to the charging dock to charge. After charging to the appropriate battery level, it will resume unfinished cleaning tasks.

**Note:** To use this function, please enable it in the app.

### Do Not Disturb (DND) Mode

When the robot is set to Do Not Disturb (DND) mode, the robot will be prevented from resuming cleaning. DND mode is disabled by default at the factory. You can use the app to enable DND mode or modify the DND period. The DND period is 22:00–8:00 by default.

**Note:**

- The scheduled cleaning tasks will be performed as usual during the DND period.
- The robot will resume cleanup where it left off after the DND period expires.

### Spot Cleaning

When the robot is awaiting, press and hold the button  for 3 seconds to enable the spot cleaning mode. In this mode, the robot cleans a square-shaped area of 1.5 × 1.5 meters around it and returns to its starting point once the spot cleaning is completed.

### Robot Restarting

If the robot stops responding or cannot be turned off, press and hold the power button for 10 seconds to forcefully turn it off. Then, press and hold the power button for 3 seconds to turn the robot on.

### Use Mopping Function

**Note:** It is recommended that all floors are vacuumed at least three times before the first mopping session to achieve a better cleaning effect.

1. Press the release clip to remove the 2-in-1 water tank with dust box.
2. Open the water inlet lid, fill the tank with water, and close the lid tightly.

**Note:**

- Do not use detergent or disinfectant.
  - Do not fill the water tank with hot water as this may cause the water tank to warp.
3. Dampen the mop pad and wring out excess water. Install the mop pad as shown in the figure.

4. Reinstall the 2-in-1 water tank with dust box and mop assembly back as shown in the figure until they click into place. Press the power button or use the app to start cleaning.

**Note:**

- It is not recommended to use the mopping function on carpets.
  - Use the app to adjust the mop pad moisture as required.
5. When the robot returns to charge after cleaning, remove the mop pad holder and clean the mop pad to prevent mildew or odors.

**Note:**

- Wash the mop pad after each use, and regularly empty the water tank of unused water.
- Remove the mop assembly when not mopping.

**Fig. D-1-Fig. D-5**

## E Routine Maintenance

### Parts

To keep the robot in good condition, it is recommended to refer to the accessory usage in the app or the following table for routine maintenance.

Part	Maintenance Frequency	Replacement Period
Mop pad	After each use	Every 3 to 6 months
Main brush	Once every 2 weeks	Every 6 to 12 months
Side brush		Every 3 to 6 months
Dust box's filter		
Charging dock's signaling area	Once every month	/
Charging contacts		
Laser distance sensor (LDS)		
Return-to-base sensor		
Bumper		
Bottom of the robot		
Omnidirectional wheel		
Cliff sensors		

Part	Maintenance Frequency	Replacement Period
Dust box	Clean it as needed	/
Main wheels		
Water tank		

**Note:** The replacement frequency will depend on your usage of the robot. If an exception occurs due to special circumstances, the parts should be replaced.

### Main Brush

1. Press the brush guard clips inwards to remove the brush guard, and lift the brush out of the robot.
2. Use a proper cleaning tool to remove any hair tangled in the brush. Then reinstall the brush and press on the brush guard to lock it in place.

Fig. E-1

### Side Brush

Remove and clean the side brush.

Fig. E-2

### Omnidirectional Wheel

Use a proper cleaning tool to remove any hair tangled in the omnidirectional wheel.

Fig. E-3

### 2-in-1 Water Tank with Dust Box

1. Press the release clip to remove the 2-in-1 water tank with dust box, and then empty the water tank.
2. Open the dust box cover and empty the dust box.
3. Open the filter holder to remove the HEPA filter and tap the HEPA filter gently.

**Note:** Do not attempt to clean the filter with a brush, a finger or sharp objects to prevent damage.

4. Rinse the dust box and HEPA filter with water and air dry them completely before reinstalling.

**Note:**

- Do not rinse the parts outside the dust box. If there are any water stains, please wipe them dry before reinstalling.
- Rinse the dust box and filter with clean water only. Do not use any detergent.
- Use the dust box and filter only when they are completely dry.

Fig. E-4

### Mop Pad

1. Remove the mop assembly and pull the mop pad off the mop pad holder.
2. Clean the mop pad with water only and dry it completely before reinstalling.

Fig. E-5

### Robot Sensors

Wipe robot sensors by using a soft and dry cloth, as shown in the below figure:

1. Laser Distance Sensor (LDS)
2. Bumper
3. Return-to-Base Sensor
4. Cliff Sensors

**Note:** A wet cloth can damage sensitive elements within the robot and the charging dock. Please use a dry cloth for cleaning.

Fig. E-6

### Charging Contacts and Signaling Area

Clean the charging contacts and the signaling area with a soft and dry cloth.

Fig. E-7

### Battery

The robot contains a high-performance lithium-ion battery pack. Make sure that the battery remains well-charged for daily use to maintain optimal battery performance. If the robot is not used for an extended period of time, turn it off and put it away. To prevent damages from over-discharging, charge the robot at least once every three months.

# Troubleshooting

Problem	Solution
The robot will not turn on.	<ul style="list-style-type: none"> <li>• The battery is low. Recharge the robot on the charging dock and try again.</li> <li>• The temperature of the battery is too low or too high. It is recommended to operate the appliance at a temperature between 32°F (0°C) and 104°F (40°C).</li> </ul>
The robot will not charge.	<ul style="list-style-type: none"> <li>• The charging dock is not connected to power, please make sure both ends of its adaptor are correctly plugged in.</li> <li>• The contact between the charging contacts on the charging dock and the robot is poor, please clean the charging contacts.</li> </ul>
The robot fails to connect to Wi-Fi.	<ul style="list-style-type: none"> <li>• The Wi-Fi network password is incorrect. Make sure the password used to connect to your Wi-Fi network is correct.</li> <li>• The robot does not support a 5 GHz Wi-Fi connection. Make sure the robot is connected to a 2.4 GHz Wi-Fi connection.</li> <li>• The Wi-Fi signal is weak. Make sure the robot is in an area with good Wi-Fi coverage.</li> <li>• The robot may not be ready to be configured. Please exit and re-enter the app, and then try again as instructed.</li> </ul>

Problem	Solution
The robot cannot return to the charging dock.	<ul style="list-style-type: none"> <li>• The route for returning to charge is blocked, e.g. the door is closed.</li> <li>• The charging dock is disconnected from power or moved when the robot is not on it. Please connect the charging dock to the power supply or place the robot onto the charging dock to charge.</li> <li>• There are too many obstructions around the charging dock. Place the charging dock in a more open area.</li> <li>• Moving the robot may cause it to re-position itself, and it will recreate a map if re-positioning fails. If the robot is too far from the charging dock, it might not be able to automatically return on its own, in which case you will need to manually place the robot onto the charging dock.</li> <li>• Wipe the signaling area on the charging dock to remove dust or debris.</li> </ul>
The robot gets stuck in front of the charging dock and cannot return to it.	<ul style="list-style-type: none"> <li>• Check whether there is enough space on both sides or in front of the charging dock to prevent the robot from being blocked.</li> <li>• The robot may slip if the floor in front of the charging dock is overly wet. If so, clean the excess water before trying again.</li> <li>• It is recommended to move the charging dock to a different place and try again.</li> </ul>

## Troubleshooting

Problem	Solution
The robot will not turn off.	<ul style="list-style-type: none"> <li>The robot cannot be turned off when it is charging. It is recommended to move the robot from the charging dock, and then press and hold the power button for 3 seconds to turn it off.</li> <li>If the robot cannot be turned off by performing step 1, press and hold the power button for 10 seconds to forcibly turn off the robot. If the problem persists, please contact after-sales service.</li> </ul>
The charging speed is slow.	<ul style="list-style-type: none"> <li>It takes about 4.5 hours to fully charge the robot when its battery is low.</li> <li>If you operate the robot at temperatures outside of the specified range, the charging speed will automatically slow down to extend the battery life.</li> <li>The charging contacts on both the robot and the charging dock may be dirty, please wipe them with a dry cloth.</li> </ul>
The noise increases while the robot is operating.	<ul style="list-style-type: none"> <li>Check whether the dust box's filter is clogged. If so, clean it or replace it.</li> <li>A hard object may be caught in the main brush or the dust box. Check and remove any hard objects.</li> <li>The main brush or the side brush may become tangled. Check and remove any foreign objects.</li> <li>Switch the suction mode to Standard or Quiet.</li> </ul>
The robot moves without following the set route.	<ul style="list-style-type: none"> <li>Objects such as power cords and slippers should be organized before using the robot.</li> <li>Working on wet slippery surfaces may cause the main wheel to slip. It is recommended to dry any wet areas before using the robot.</li> </ul>

Problem	Solution
The robot misses the rooms to be cleaned.	<ul style="list-style-type: none"> <li>Make sure that the doors of the rooms to be cleaned are open.</li> <li>Check whether there is a threshold higher than 2 cm at the door of the room. The robot cannot climb over high thresholds or steps.</li> <li>The place in front of the room to be cleaned may be wet and slippery, causing the robot to slip and work abnormally. Please try drying the floor before using the robot.</li> </ul>
The robot will not resume cleaning after charging.	<ul style="list-style-type: none"> <li>Make sure that the robot is not set to the Do Not Disturb (DND) mode, which will prevent it from resuming cleaning.</li> <li>The robot will not resume cleaning after you manually place the robot on the charging dock or send the robot to charge via the app or the button .</li> </ul>
No water comes out of the water tank, or only a little bit comes out.	<ul style="list-style-type: none"> <li>Check whether there is water inside the water tank.</li> <li>Clean the mop pad if it becomes dirty.</li> <li>Make sure the mop pad and the mop pad holder is installed correctly according to the user manual.</li> </ul>
The robot is malfunctioning.	<ul style="list-style-type: none"> <li>Turn off the robot and then reactivate it.</li> </ul>

## Troubleshooting

Problem	Solution
The robot no longer cleans efficiently or leaves dust behind.	<ul style="list-style-type: none"><li>• The dust box is full. Please clean it.</li><li>• The filter is blocked. Please clean it.</li><li>• A foreign object is caught in the main brush. Please clean it.</li></ul>
The robot does not perform scheduled cleaning.	<ul style="list-style-type: none"><li>• The robot has low battery. Scheduled cleaning will not start unless the robot has at least 15% battery left.</li></ul>

For more support, contact us via <https://global.dreametech.com>.

# Specifications

## Robot

Model	RLF41GA
Charging Time	Approx. 4.5 hours
Rated Voltage	14.4 V $\overline{=}$
Rated Power	45 W
Operation Frequency	2400-2483.5 MHz
Maximum Output Power	< 20 dBm

Under normal use of condition, this equipment should be kept a separation distance of at least 20 cm between the antenna and the body of the user.

## Rechargeable Lithium-ion Battery Pack

Model	C1251A6
Type	Li-ion
Number	1
Rated Capacity	2.95 Ah

## Charging dock

Model	RCFA0301
Rated Input	20 V $\overline{=}$ 1 A
Rated Output	20 V $\overline{=}$ 1 A

## Adaptor

Manufacturer	Shenzhen CHANZEHO Technology Co., Limited
Model	CZH024N200100EUWA1
Rated Input	100-240 V~ 50/60 Hz 0.8 A Max
Rated Output	20 V $\overline{=}$ 1 A 20 W
Average Active Efficiency	85.47%
Efficiency at Low Load (10%)	81.30%
No-load Power Consumption	< 0.1 W

## Battery Disposal and Removal

The built-in lithium-ion battery contains substances that are hazardous to the environment. Before disposing of the battery, make sure the battery is removed by qualified technicians and discarded at an appropriate recycling facility.

- the battery must be removed from the appliance before it is scrapped;
- the appliance must be disconnected from the supply mains when removing the battery;
- the battery is to be disposed of safely.

### CAUTION:

Before removing the battery, disconnect the power and run out the battery as much as possible.

Unneeded batteries should be discarded at an appropriate recycling facility.

Do not expose to high temperature environment to avoid risks of explosion.

Under abusive conditions, liquid may be ejected from the battery. If contact occurs, flush with water and seek medical help.

### Removal Guide:

1. Turn over the robot, use a proper tool to remove the screws on the back of the robot, and then remove the cover.
2. Unplug the terminals between the battery and PCB board to remove the battery.

## WEEE Information



All products bearing this symbol are waste electrical and electronic equipment (WEEE as in directive 2012/19/EU) which should not be mixed with unsorted household waste. Instead, you should protect human health and the environment by handing over your waste equipment to a designated collection point for the recycling of waste electrical and electronic equipment, appointed by the government or local authorities. Correct disposal and recycling will help prevent potential negative consequences to the environment and human health. Please contact the installer or local authorities for more information about the location as well as terms and conditions of such collection points.

## Güvenlik Bilgisi

Cihazın uygunsuz kullanımının yol açtığı elektrik çarpması, yangın veya yaralanmadan kaçınmak için cihazı kullanmadan önce kullanım kılavuzunu dikkatlice okuyun ve ileride başvurmak üzere saklayın.

### Kullanım Sınırlamaları

- Bu ürün, güvenli kullanımı sağlamak ve risklerden kaçınmak üzere, 8 yaşından küçük çocuklar ve fiziksel, duyuşsal, zihinsel engelli kişiler veya sınırlı deneyime veya bilgiye sahip kişiler tarafından bir ebeveyn veya vasinin gözetimi olmadan kullanılmamalıdır. Temizlik ve bakım, gözetim olmaksızın çocuklar tarafından yapılmamalıdır.
- Çocuklar bu ürünle oynamamalıdır. Robot çalışırken çocukların ve evcil hayvanların robotla aralarında güvenli bir mesafe bulunduğundan emin olun.
- Bu ürün yalnızca ev ortamındaki zemin temizliği içindir. Dış mekânlarda, zemin harici yüzeylerde veya ticari ya da endüstriyel ortamlarda kullanmayın.
- Adaptör zarar görür veya arızalanırsa, kullanmayı derhal bırakın ve satış sonrası servisle iletişime geçin.
- Robotu, koruyucu bariyeri olmayan zemin üzeri asma alanlarda kullanmayın.
- Robotu baş aşağı çevirip koymayın. LMS kapağını, robot kapağını veya tamponu robot tutup taşımak için kullanmayın.
- Robotu, ortam sıcaklığının 0°C'nin üzerinde ve 40°C'nin altında olduğu ortamlarda kullanın. Zeminde sıvı veya yapışkan madde olmadığından emin olun.
- Robotu kullanmadan önce takılıp çekilmemesi için yerdeki kabloları toplayın.
- Robotun çarparak zarar vermesini önlemek için kırılğan ve küçük nesnelere yerden kaldırın.

## Güvenlik Bilgisi

- Bir nesneye takılıp sürüklenmenin verebileceği zarardan kaçınmak için cihazı çalıştırmadan önce bir yere sabit olmayan nesnelere yerden kaldırmayı ve temizlik güzergahı üzerindeki kabloları veya elektrik kablolarını toplayın.
- Saç, parmak ve diğer vücut bölgelerini robotun emici ağzından uzak tutun.
- Fırça temizlik aracını çocukların erişemeyeceği bir yerde saklayın.
- Gerek durduğunuz, gerek hareket ettiğiniz sırada çocukları, evcil hayvanları ve diğer nesnelere robotun üzerine bindirmeyin/koymayın.
- Robotu yanan nesnelere temizlemek için kullanmayın. Robotu yanıcı veya kolay tutuşabilen sıvıları, aşındırıcı gazları veya seyreltilmemiş asit ya da çözücü maddeleri toplamak için kullanmayın.
- Sert veya keskin nesnelere süpürmeyin. Cihazı taş, büyük kâğıt parçaları veya cihazı tıkayabilecek diğer malzemeler gibi nesnelere toplamak için kullanmayın.
- Robot süpürge temizliği ve bakımına başlamadan önce robotun kapalı olduğundan ve şarj yavaşlama noktasının fişe takılı olmadığından emin olun.
- Robotu veya şarj yavaşlama noktasını silmek için nemli bez kullanmayın veya herhangi bir sıvıya maruz bırakmayın. Yıkabilir parçaları yerlerine takılmadan ve kullanılmadan önce tamamen kurutulmalıdır.
- Robot nakledilirken kapalı olduğundan ve mümkünse orijinal paketinde tutulduğundan emin olun.
- Lütfen bu ürünü Kullanıcı Kılavuzundaki talimatlara uygun bir şekilde kullanın. Bu ürünün uygunsuz kullanımından kaynaklanan kayıp veya zararlardan kullanıcılar sorumludur.

## Güvenlik Bilgisi

### Piller ve Şarj

- UYARI: Şarj edilemeyen türdeki piller şarj edilmemelidir.
- Üçüncü taraflara ait pil, adaptör veya şarj yavaşma noktası kullanmayın. Yalnızca RCFA0301 besleme birimi kullanın.
- Pili veya şarj yavaşma noktasını kendi başınıza sökmeye, onarmaya veya modifiye etmeye çalışmayın.
- Şarj yavaşma noktasını bir ısı kaynağının yakınına koymayın.
- Yavaşma noktasının şarj kontaklarını silmek veya temizlemek için ıslak bez veya ıslak ellerinizi kullanmayın.
- Kullanılmış pilleri uygun olmayan bir şekilde imha etmeyin. İhtiyaç fazlası piller uygun bir geri dönüşüm tesisinde imha edilmelidir.
- Robot uzun süre kullanılmıyacaksa tamamen şarj edin, ardından kapatın ve serin, kuru bir yerde saklayın. Pilin aşırı derecede boşalmasını önlemek için robotu en az her 3 ayda bir tekrar şarj edin.
- Bu ürün yalnızca yetkin teknisyenler veya satış sonrası servis tarafından değiştirilebilecek piller içerir.

### Lazer Güvenlik Bilgileri

- Bu ürünlerdeki lazer sensörü, Sınıf 1 lazer ürünleri için IEC 60825-1:2014/EN 60825-1:2014/A11:2021 Standardına uyar. Kullanım sırasında lütfen doğrudan gözle temasından kaçınınız.

SINIF 1 LAZER ÜRÜNÜ  
TÜKETİCİ LAZER ÜRÜNÜ  
EN 50689:2021

## Güvenlik Bilgisi



Yalnızca iç mekânlarda kullanım içindir



Kullanıcı kılavuzunu okuyun

Bu belgeyle, Dreame Trading (Tianjin) Co., Ltd. RLF41GA telsiz ekipman türünün 2014/53/EU sayılı Direktif ile uyumlu olduğunu beyan eder. AB uygunluk beyanının tam metnini şu internet adresinde bulabilirsiniz: <https://global.dreametech.com>  
Ayrıntılı e-kılavuz için lütfen tıklayınız: <https://global.dreametech.com/pages/user-manuals-and-faq>

## A Ürün Genel Bilgileri

### Robot

- Güç/Temizleme Düğmesi
    - Açmak veya kapatmak için 3 saniye basılı tutun
    - Robot açıldıktan sonra temizliğe başlamak için basın
  - Yanaşma/Nokta Temizliği Düğmesi 
    - Robotu şarj yanaşma noktasına geri göndermek için basın
    - Nokta temizliği başlatmak için düğmesini 3 saniye basılı tutun
- Pil Durumu Göstergesi
- Sabit Beyaz: Temizlik tamamlandı
  - Yanıp Sönen Turuncu: Hata
  - Yavaş Yanıp Sönen Beyaz: Pil gücü düşük değilken robot şarj oluyor
- Not:**
- Robot temizlik yaparken veya şarj olmak üzere geri dönerken, üzerindeki herhangi bir düğmeye basarak robotu duraklatabilirsiniz.
  - Kablosuz interneti sıfırlamak için güç düğmesini ve yanaşma düğmesini 3 saniye süreyle basılı tutun.
  - Çocuk Kilidi Dreamehome uygulaması aracılığıyla etkinleştirilebilir/devre dışı bırakılabilir.
- LMS Kapağı
  - Lazer Mesafe Sensörü (LMS)
  - Tampon
  - Yan Fırça
  - Ana Tekerlek
  - Uçurum Sensörleri
  - Çok Yönlü Tekerlek

- Fırça Muhafazası Klipsleri
- Ana Tekerlek
- Ana Fırça
- Fırça Muhafazası
- Sıfırlama Düğmesi
  - Fabrika ayarlarını geri yüklemek için 3 saniye basılı tutun
- Şarj Kontakları
- Toz Kutulu İki Bir Arada Su Haznesi
- İstasyona Dönme Sensörü
- Paspas Tertibatı

### Şekil A-1

#### Toz Kutulu İki Bir Arada Su Haznesi

- Filtre Tutucu
- HEPA Filtre
- Su Giriş Ağız Kapağı
- Su Giriş Ağız
- Serbest Bırakma Klipsi

### Şekil A-2

#### Paspas Tertibatı

- Paspas Pedi Tutucusu
- Serbest Bırakma Klipsleri
- Paspas Pedi Eklenti Alanı
- Paspas Pedi

### Şekil A-3

#### Şarj Yanaşma Noktası

- Şarj Kontakları
- Sinyal Alanı
- Güç Bağlantı Noktası

### Şekil A-4

## B Evinizin Hazırlanması

TR

- Temizliğe başlamadan önce lütfen sabit durmayan, kırılabilir, değerli veya tehlikeli eşyaları ortadan kaldırın, robotun takılarak, çizerek veya vurarak hasar vermemesi için yerdeki kabloları, giysileri, oyuncakları, sert nesnelere veya keskin nesnelere kaldırın/düzenleyin.
- Temizliğe başlamadan önce, robotun güvenli ve sorunsuz bir şekilde çalışması için merdivenlerin kenarlarına fiziksel bir engel koyun.
- Temizlenecek odanın kapısını açın ve mobilyaları kendi yerlerine koyarak daha fazla alan açın.
- Robotun temizlenmesi gereken alanları kaçırmamasının önüne geçmek için robotun önünde, bir eşikte, koridorda veya dar yerlerde durmayın.

### Not:

- Robotu ilk kez çalıştırdığınızda engel çıkarabilecek şeyleri zamanında kaldırmak için temizlik yaparken robotu takip edin.
- Taş, çelik bilye ve oyuncak parçaları gibi sert nesnelere veya inşaat atığı, cam kırığı veya çivi gibi keskin nesnelere süpürmeyin, aksi takdirde zemin çizilebilir.

### Şekil B

## C Kullanmadan Önce

### 1. Şarj Yanaşma Noktasını Yerleştirin ve Bir Elektrik Prizine Bağlayın

Şarj yanaşma noktasının altındaki çift taraflı bantı soyun. Şarj yanaşma noktasını, etrafı mümkün olduğunca açık ve kablosuz interneti iyi çeken bir yere yerleştirin. Şekilde gösterildiği gibi yeterli alan bırakın ve taralı alandaki nesnelere kaldırmayın. Adaptörü şarj yanaşma noktasına takın ve prize bağlayın.

#### Not:

- Şarj yanaşma noktasına önden 1,5 m'den ve her iki yandan 0,5 m'den yakın olan tüm nesnelere kaldırmayın.
- Şarj yanaşma noktasını doğrudan güneş ışığı alan bir yere veya diğer objelerin sinyali engelleyebileceği bir yere yerleştirmeyin çünkü bu robotun şarj yanaşma noktasına dönmesini engelleyebilir.
- Su lekelerinin aşşap zeminleri veya halıları ıslatmasını engellemek için şarj yanaşma noktasının seramik veya mermer zeminlere yerleştirilmesi önerilir.

### 2. Korumaları Çıkarın ve Yan Fırçayı Takın

### 3. Dreamehome Uygulaması ile Bağlayın

- (1) Robotu açmak için robot üzerindeki güç düğmesini 3 saniye süreyle basılı tutun. Uygulamayı indirmek ve yüklemek için robot üzerindeki QR kodunu taratın veya uygulama mağazasında "Dreamehome"u arayın.
- (2) Dreamehome uygulamasını açın, "Bağlanmak için QR kodunu tara"ya dokununuz ve cihazı eklemek için robot üzerindeki QR kodunu

tekrar taratın. Kablosuz internet bağlantısını tamamlamak için lütfen talimatları izleyin.

- ① QR kodu
- ② Kablosuz İnternet Göstergesi

- Yanıp sönme: Bağlanacak / Bağlanıyor
- Açık: Bağlandı

#### Not:

- Yalnızca 2.4 GHz kablosuz internet desteklenir.
- Kablosuz interneti sıfırlamak için (2) adımı tekrarlayın ve ardından kablosuz internet bağlantısını tamamlamak için ekrandaki talimatları izleyin.
- Cihazı kablosuz internet ağından ayırmak için robot süpürgenin üzerindeki Sıfırlama Düğmesini 3 saniye basılı tutun.
- Uygulama yazılımındaki güncellemeler nedeniyle, gerçek işlemler kılavuzdaki yönergelerden farklı olabilir. Lütfen güncel uygulama sürümüne dayalı olarak talimatları izleyin.

### 4. Robotu Şarj Edin

Robotu yerleştirirken, robotun şarj kontaklarını şarj yanaşma noktasının şarj kontakları ile hizaladığınızda robot otomatik olarak açılır ve şarj olmaya başlar.

Robot tamamen şarj olduktan sonra, robot ve şarj yanaşma noktası üzerindeki durum göstergeleri 10 saniye süreyle yanar ve ardından söner.

**Not:** Robotu ilk kez kullanmadan önce tamamen şarj etmeniz önerilir. Pil tükendiği için robot açılmadığı takdirde robotu şarj etmeye üzere şarj yanaşma noktasına kendiniz bağlayın.

### Şek. C-1-Şek. C-4

## D Kullanım

### Açma/Kapatma

Robotu açmak için güç düğmesini 3 saniye süreyle basılı tutun. Güç göstergesi yanmalıdır. Robotu şarj yanaşma noktasına yerleştirin, robot otomatik olarak açılmalı ve şarj olmaya başlamalıdır. Robotu kapatmak için robotu şarj yanaşma noktasından uzaklaştırın ve güç düğmesini 3 saniye süreyle basılı tutun.

### Hızlı Harita Çıkarma

Ağı ilk kez yapılandırdıktan sonra, hızlı bir şekilde bir harita oluşturmak için uygulamadaki talimatları izleyin. Robot, temizliğe başlamadan harita çıkarmaya başlayacaktır. Robot şarj yanaşma noktasına döndüğünde, haritalandırma işlemi tamamlanmış olup harita otomatik olarak kaydedilir.

### Temizliğe Başlama

Robot açıldıktan sonra temizliğe başlamak için güç düğmesine basın. Robot doğru bir şekilde bir rota çıkarır, kenarları ve duvar önlerini sistematik bir şekilde temizler, ardından kapsamlı bir iş için her odayı S şeklinde bir desen izleyip temizleyerek işi tamamlar.

**Not:** Robotun temizliğe şarj yanaşma noktasından başlaması önerilir. Robot temizlenirken şarj yanaşma noktasını hareket ettirmeyin. Böylece robot şarj yanaşma noktasına sorunsuz bir şekilde dönebilir.

## Duraklatma/Uyku

Robot çalışırken herhangi bir düğmeye basarak robotu duraklatabilirsiniz.

Robotun duraklama süresi 10 dakikayı aştığı takdirde otomatik olarak uyku moduna geçer. Robot üzerindeki tüm göstergeler kapanır. Robot üzerindeki herhangi bir düğmeye basarak ya da uygulamayı kullanarak robotu uyandırabilirsiniz.

**Not:** Robot duraklatılıp şarj yanaşma noktasına yerleştirildiği takdirde geçerli temizlik işlemi sona erer.

## Temizliğe Otomatik Olarak Devam Etme

Pil çok azaldığı takdirde robot şarj olmak için otomatik olarak şarj yanaşma noktasına döner. Uygun pil seviyesine kadar şarj olduktan sonra, henüz tamamlanmamış olan temizlik görevlerine kaldığı yerden devam eder.

**Not:** Bu işlevi kullanmak için lütfen uygulama içinde etkinleştirin.

## Rahatsız Etmeyin (DND) Modu

Robot Rahatsız Etmeyin (DND) moduna ayarlandığında robotun temizliğe kaldığı yerden devam etmesi engellenir. DND modu, fabrika ayarlarında varsayılan olarak devre dışıdır. Uygulama üzerinden DND modunu etkinleştirebilir veya DND süresini değiştirebilirsiniz. DND süresi, varsayılan olarak 22:00–8:00 olarak ayarlanmıştır.

**Not:**

- Programlanmış temizlik görevleri DND süresi boyunca normal bir şekilde yerine getirilir.

- DND süresi sona erdikten sonra robot temizliğe kaldığı yerden devam eder.

## Nokta Temizliği

Robot beklerken  düğmesini 3 saniye basılı tutarak nokta temizliği modunu etkinleştirebilirsiniz. Bu modda, robot etrafındaki 1,5 x 1,5 metre karelik alanı temizler ve nokta temizliği tamamlandığında başlangıç noktasına geri döner.

## Robotu Tekrar Başlatmak

Robot yanıt vermeyi durdurursa veya kapatılmazsa cihazı zorla kapatmak için güç düğmesini 10 saniye basılı tutun. Ardından robotu açmak için güç düğmesini 3 saniye basılı tutun.

## Paspaslama İşlevini Kullanmak

**Not:** Daha iyi bir temizlik etkisine ulaşmak için ilk paspaslama seansına başlamadan önce tüm zeminlerin en az üç kez süpürülmesi önerilir.

1. Klipse bastırarak toz kutulu ikisi bir arada su haznesini çıkarın.
2. Su giriş ağız kapağını açın, hazneyi suyla doldurun, ardından kapağı sıkıca kapatın.

**Not:**

- Deterjan veya dezenfektan kullanmayın.
- Su haznesinin esnemesine neden olabileceğinden su haznesini sıcak suyla doldurmayın.

3. Paspas pedini ıslatıp fazla suyu sıkın. Paspas pedini şekilde gösterildiği gibi takın.
4. Toz kutulu ikisi bir arada su haznesi ve paspas tertibatını, şekilde gösterildiği gibi klik sesi duyacak şekilde yerine yerleştirin. Temizliği başlatmak için güç düğmesine basın veya uygulamayı kullanın.

**Not:**

- Paspas fonksiyonunun halılar üzerinde kullanılması önerilmez.
  - Uygulamayı kullanarak paspas pedi ıslaklık seviyesini ihtiyaca göre ayarlayın.
5. Robot süpürge temizlikten sonra şarj olmak için döndüğünde, paspas pedi tutucuyu çıkarın ve küf veya koku oluşmasını önlemek için paspas pedini temizleyin.

**Not:**

- Paspas pedini her kullanımdan sonra yıkayın ve kirlı su haznesini düzenli olarak boşaltın.
- Paspaslama yapılmadığında paspas tertibatını çıkarın.

## Şek. D-1-Şek. D-5

## E Rutin Bakım

### Parçalar

Robotun düzgün çalışmaya devam etmesi amacıyla rutin bakım için uygulamadaki aksesuar kullanımı bölümüne veya aşağıdaki tabloya bakılması önerilir.

Parça	Bakım Sıklığı	Değiştirme Süresi
Paspas pedi	Her kullanımdan sonra	Her 3-6 ayda bir
Ana fırça	2 haftada bir	Her 6-12 ayda bir
Yan fırça		Her 3-6 ayda bir
Toz kutusu filtresi		
Şarj yavaşma noktası sinyali alanı	Ayda bir kez	/
Şarj kontakları		
Lazer mesafe sensörü (LMS)		
İstasyona dönme sensörü		
Tampon		
Robotun alt kısmı		
Çok yönlü tekerlek		
Uçurum sensörleri		

Parça	Bakım Sıklığı	Değiştirme Süresi
Toz kutusu	Gereken sıklıkta temizleyin	/
Ana tekerlekler		
Su haznesi		

**Not:** Değiştirme sıklığı, robotu kullanımınıza bağlı olacaktır. Özel koşullar nedeniyle istisnai bir durum meydana geldiği takdirde parçalar değiştirilmelidir.

### Ana Fırça

1. Fırça muhafazası klipslerini içe doğru bastırarak fırça muhafazasını çıkarın ve fırçayı kaldırarak robottan çıkarın.
2. Fırçaya takılan saçları uygun bir temizlik aracıyla temizleyin. Ardından fırçayı yerine takın ve fırça muhafazasına bastırarak fırçayı yerine kilitleyin.

### Şekil E-1

### Yan Fırça

Yan fırçayı çıkarıp temizleyin.

### Şekil E-2

### Çok Yönlü Tekerlek

Çok yönlü tekerleğe takılan saçları uygun bir temizlik aracıyla temizleyin.

### Şekil E-3

### Toz Kutulu İki Bir Arada Su Haznesi

1. Klipse bastırarak toz kutulu ikisi bir arada su haznesini çıkarın ve ardından su haznesini boşaltın.
2. Toz kutusu kapağını açın ve toz kutusunu boşaltın.
3. Filtre tutucuyu açıp HEPA filtreyi çıkarın ve HEPA filtreye nazikçe vurun.

**Not:** Hasar görmemesi için, filtreyi bir fırçayla, parmakla veya keskin nesnelere temizlemeye çalışmayın.

4. Toz kutusunu ve HEPA filtreyi suyla yıkayın ve yerlerine takmadan önce tamamen kurutun.

### Not:

- Toz kutusunun dışındaki parçaları yıkamayın. Su lekesi varsa parçaları yerlerine takmadan önce lütfen bu lekeleri silin.
- Toz kutusunu ve filtreyi yalnızca temiz suyla yıkayın. Deterjan kullanmayın.
- Toz kutusunu ve filtreyi tamamen kuruduktan sonra kullanın.

### Şekil E-4

### Paspas Padi

1. Paspas tertibatını çıkarın ve paspas pedini paspas pedi tutucudan çekip çıkarın.
2. Paspas pedini yalnızca suyla temizleyin ve yerine takmadan önce tamamen kurutun.

### Şekil E-5

### Robot Sensörleri

Robot sensörlerini, aşağıdaki şekilde gösterildiği gibi yumuşak ve kuru bir bezle silin.

1. Lazer Mesafe Sensörü (LMS)
2. Tampon
3. İstasyona Dönme Sensörü
4. Uçurum Sensörleri

**Not:** Nemli bez, robot içindeki ve şarj yamaştırma noktasındaki hassas parçalara zarar verebilir. Temizlik sırasında lütfen kuru bir bez kullanın.

### Şekil E-6

### Şarj Kontakları ve Sinyal Alanı

Şarj kontaklarını ve sinyal alanını yumuşak ve kuru bir bezle temizleyin.

### Şekil E-7

### Pil

Robot, yüksek performanslı lityum iyon pil takımı içerir. En uygun pil performansını muhafaza etmek üzere lütfen günlük kullanım için şarjın yeterli olduğundan emin olun. Robot uzun süre kullanılmıyorsa kapatın ve kaldırın. Şarjın aşırı boşalmasından kaynaklanacak zararı önlemek için robotu en az her üç ayda bir yeniden şarj edin.

## Sorun giderme

Sorun	Çözüm
Robot açılmıyor.	<ul style="list-style-type: none"> <li>Pil azalmış. Robotu şarj yavaşma noktasında yeniden şarj edip tekrar deneyin.</li> <li>Pilin sıcaklığı çok düşük veya çok yüksek. Cihazın 32°F (0°C) ile 104 °F (40°C) arası bir sıcaklıkta çalıştırılması önerilir.</li> </ul>
Robot şarj olmuyor.	<ul style="list-style-type: none"> <li>Şarj yavaşma noktası güce bağlı olmayabilir, lütfen adaptörün her iki ucunun da doğru şekilde takılı olduğundan emin olun.</li> <li>Şarj yavaşma noktası üzerindeki şarj kontakları ile robot arasındaki temas zayıf olabilir, lütfen şarj kontaklarını temizleyin.</li> </ul>
Robot kablosuz internete bağlanamıyor.	<ul style="list-style-type: none"> <li>Kablosuz internet ağ şifresi yanlış olabilir. Kablosuz internet ağınıza bağlanmak için kullanılan şifrenin doğru olduğunu kontrol edin.</li> <li>Robot 5 GHz Kablosuz İnternet bağlantısını desteklemiyor. Robotun 2.4 GHz Kablosuz İnternet bağlantısına bağlı olduğundan emin olun.</li> <li>Kablosuz internet sinyali zayıf. Robotun, kablosuz internet kapsamı iyi olan bir alanda olduğundan emin olun.</li> <li>Robot yapılandırılmaya hazır olmayabilir. Lütfen uygulamadan çıkıp yeniden giriş yapın ve talimatları takip ederek tekrar deneyin.</li> </ul>

Sorun	Çözüm
Robot şarj yavaşma noktasına dönemiyor.	<ul style="list-style-type: none"> <li>Şarj olmak için döndüğü yolda engel olabilir, örneğin kapı kapalı olabilir.</li> <li>Şarj yavaşma noktasının güç bağlantısı kesilmiş veya istasyon robot orada değilken yerinden oynatılmış olabilir. Lütfen şarj yavaşma noktasını güç kaynağına bağlayın veya robotu şarj olması için şarj yavaşma noktasının üzerine yerleştirin.</li> <li>Şarj yavaşma noktası etrafında çok sayıda engel var. Şarj yavaşma noktasını daha açık bir alana yerleştirin.</li> <li>Robotu yerinden oynatmak kendini yeniden konumlandırmasına neden olabilir; yeniden konumlandırma başarısız olursa tekrar bir harita oluşturacaktır. Robot, şarj yavaşma noktasından çok uzaktaysa kendi başına otomatik olarak geri dönemeyebilir; bu durumda robotu şarj yavaşma noktasına manuel olarak yerleştirmeniz gerekmektedir.</li> <li>Şarj yavaşma noktasının sinyal alanını silerek toz veya kalıntıları giderin.</li> </ul>
Robot, şarj yavaşma noktasının önünde takılı kalıyor ve istasyona geri dönemiyor.	<ul style="list-style-type: none"> <li>Robotun takılmasını önlemek için şarj yavaşma noktasının her iki tarafında veya önünde yeterli alan olup olmadığını kontrol edin.</li> <li>Şarj yavaşma noktasının önündeki zemin aşırı ıslak ise robot kayabilir. Aşırı ıslaksa tekrar denemeden önce fazla suyu temizleyin.</li> <li>Şarj yavaşma noktasının farklı bir yere taşınması ve tekrar denemesi önerilir.</li> </ul>

## Sorun giderme

Sorun	Çözüm
Robot kapanmıyor.	<ul style="list-style-type: none"> <li>Robot şarj olurken kapatılamaz. Robotu şarj yanaşma noktasından uzaklaştırmanız ve ardından kapatmak için güç düğmesini 3 saniye basılı tutmanız önerilir.</li> <li>Robot 1. adım uygulanarak kapatılmadığı takdirde robotu zorla kapatmak için güç düğmesini 10 saniye basılı tutun. Sorun devam ederse lütfen satış sonrası servis ile iletişime geçin.</li> </ul>
Şarj hızı düşük.	<ul style="list-style-type: none"> <li>Pil azaldığında robotun tamamen şarj olması yaklaşık 4,5 saat sürer.</li> <li>Robotu belirtilen aralığın dışındaki sıcaklıklarda çalıştırırsanız şarj hızı otomatik olarak yavaşlayarak pil ömrünü uzatır.</li> <li>Hem robotun hem de şarj yanaşma noktasının şarj kontakları kirliliği olabilir, lütfen kuru bir bezle silin.</li> </ul>
Robot çalışırken gürültü artıyor.	<ul style="list-style-type: none"> <li>Toz kutusu filtresinin tıkalı olup olmadığını kontrol edin. Tıkalıysa temizleyin veya değiştirin.</li> <li>Ana fırçaya veya toz kutusuna sert bir nesne takılmış olabilir. Sert nesne olup olmadığını kontrol edin ve varsa çıkarın.</li> <li>Ana fırça veya yan fırçaya bir şeyler takılmış olabilir. Yabancı nesne olup olmadığını kontrol edin ve varsa çıkarın.</li> <li>Emme modunu Standart veya Sessiz'e getirin.</li> </ul>
Robot, belirlenen rotayı takip etmeden hareket ediyor.	<ul style="list-style-type: none"> <li>Robot kullanılmadan önce güç kabloları ve terlikler gibi nesnelere düzenlenmelidir.</li> <li>Islak kaygan yüzeylerde çalıştırma ana tekerleğin kaymasına neden olabilir. Robotu kullanmadan önce ıslak alanların kurutulması önerilir.</li> </ul>

Sorun	Çözüm
Robot, temizlenmesi gereken odaları atlıyor.	<ul style="list-style-type: none"> <li>Temizlenecek odaların kapılarının açık olduğunu kontrol edin.</li> <li>Odanın kapısında 2 cm'den yüksek bir eşik olup olmadığını kontrol edin. Robot yüksek eşiklere veya basamaklara tırmanamaz.</li> <li>Temizlenecek odanın önündeki alan ıslak veya kaygan olup robotun kaymasına ve anormal çalışmasına neden olabilir. Lütfen robotu kullanmadan önce yeri kurutmaya çalışın.</li> </ul>
Robot şarj olduktan sonra temizliğe kaldığı yerden devam etmiyor.	<ul style="list-style-type: none"> <li>Robotun Rahatsız Etmeyin (DND) moduna ayarlanmadığından emin olun; bu, temizliğe kaldığı yerden başlatılmasını engeller.</li> <li>Siz robotu şarj yanaşma noktasına kendiniz yerleştirdikten veya uygulama ya da  düğmesi üzerinden robotu şarj olmaya gönderdikten sonra robot temizliğe kaldığı yerden devam etmez.</li> </ul>
Su haznesinden su gelmez veya yalnızca çok az geliyor.	<ul style="list-style-type: none"> <li>Su haznesinin içinde su olup olmadığını kontrol edin.</li> <li>Kirlendiği takdirde paspas pedini temizleyin.</li> <li>Paspas pedinin ve paspas pedi tutucusunun kullanıcı kılavuzuna uygun bir şekilde doğru takıldığından emin olun.</li> </ul>
Robot arızalı.	<ul style="list-style-type: none"> <li>Robotu kapatın ve ardından yeniden etkinleştirin.</li> </ul>

## Sorun giderme

Sorun	Çözüm
Robot artık verimli temizlik yapmıyor ve arkasında toz bırakıyor.	<ul style="list-style-type: none"><li>• Toz kutusu dolu. Lütfen temizleyin.</li><li>• Filtre bloke oldu. Lütfen temizleyin.</li><li>• Ana fırçaya yabancı bir nesne takıldı. Lütfen temizleyin.</li></ul>
Robot programlanmış temizliği yapmıyor.	<ul style="list-style-type: none"><li>• Robotun pil seviyesi düşük. Robotun pili en az %15 olmadıkça planlanmış temizlik başlamayacaktır.</li></ul>

Daha fazla destek için bizimle <https://global.dreametech.com> üzerinden iletişime geçebilirsiniz.

## Teknik özellikler

### Robot

Model	RLF41GA
Şarj Süresi	Yaklaşık 4,5 saat
Nominal Gerilim	14,4 V ---
Nominal Güç	45 W
Çalışma Frekansı	2400-2483,5 MHz
Maksimum Çıkış Gücü	< 20 dBm

Bu ekipmanda, normal kullanım koşulları altında anten ile kullanıcının vücudu arasında en az 20 cm'lik mesafe olmalıdır.

### Şarj Edilebilir Lityum İyon PİL Takımı

Model	C1251A6
Tür	Lityum iyon
Sayı	1
Nominal kapasite	2,95 Ah

### Şarj yavaşlama noktası

Model	RCFA0301
Çalışma Girişi	20 V --- 1 A
Çalışma Çıkışı	20 V --- 1 A

### Adaptör

Üretici	Shenzhen CHANZEHO Technology Co., Limited
Model	CZH024N200100EUWA1
Çalışma Girişi	100-240 V ~ 50/60 Hz 0,8 A Maks
Çalışma Çıkışı	20 V --- 1 A 20 W
Ortalama Aktif Verimlilik	%85,47
(%10) Düşük Yükte Verimlilik	%81,3
Yüksüz Durumda Güç Tüketimi	< 0,1 W

## Pillerin Çıkarılması ve İmhası

Üründeki lityum-iyon pil, çevreye zararlı maddeler içerir. Pili atmadan önce, yetkin teknisyenler tarafından çıkarılmasını sağlayın ve uygun bir geri dönüşüm tesisinde imha edileceğinden emin olun.

- cihaz iskartaya çıkarılmadan önce pilleri çıkarılmalıdır;
- piller çıkarılırken cihaz şebeke elektriğinden ayrılmış olmalıdır;
- pil güvenli bir şekilde imha edilmelidir.

### DİKKAT:

Pili çıkarmadan önce, güç kablosunu ayırın ve pili olabildiğince fazla tüketin.

İhtiyaç fazlası piller uygun bir geri dönüşüm tesisinde imha edilmelidir.

Patlama risklerinin önüne geçmek için yüksek sıcaklıklı ortamlara maruz bırakmayın.

Kötü koşullar altında, pilden sıvı sızabilir. Temas meydana gelirse ilgili bölgeyi suyla yıkayın ve tıbbi yardım alın.

### Çıkarma Kılavuzu:

1. Robotu ters çevirin, uygun bir aletle robotun arkasındaki vidaları sökün ve ardından kapağı çıkarın.
2. Pili çıkarmak için pil ile PCB kartı arasındaki bağlantı uçlarını çıkarın.

## WEEE Bilgileri



Bu sembolü taşıyan tüm ürünler elektrikli ve elektronik cihaz atığı (2012/19/AB sayılı direktifteki anlamıyla WEEE) kapsamında olup sınıflandırılmamış ev atıklarıyla karıştırılmamalıdır. Bunun yerine, atık cihazınızı, atık elektrikli ve elektronik cihazların geri dönüştürülmesi için hükümet veya yerel yetkililer tarafından belirlenmiş olan toplama noktasına teslim ederek insan sağlığını ve çevreyi korumalısınız. Doğru imha ve geri dönüşüm, çevre ve insan sağlığı üzerindeki olası olumsuz sonuçların engellenmesine yardımcı olacaktır. Bu tür toplama noktalarının konumu, şartları ve koşulları hakkında daha fazla bilgi almak için lütfen montaj yetkilisiyle veya yerel yetkililerle iletişime geçin.

## Thông tin an toàn

Để tránh bị điện giật, hỏa hoạn hoặc thương tích do sử dụng thiết bị sai quy cách, vui lòng đọc kỹ hướng dẫn sử dụng trước khi sử dụng thiết bị và giữ lại để tham khảo sau này.

### Hạn Chế Sử Dụng

- Không để trẻ em dưới 8 tuổi cũng như những người có khiếm khuyết về thể chất, giác quan, trí tuệ hoặc hạn chế về kinh nghiệm hoặc kiến thức sử dụng sản phẩm này mà không có sự giám sát của cha mẹ hoặc người giám hộ để đảm bảo vận hành an toàn và tránh mọi rủi ro. Không để trẻ em thực hiện công việc vệ sinh và bảo trì mà không có sự giám sát.
- Không để trẻ em chơi với sản phẩm này. Giữ khoảng cách an toàn giữa trẻ em và vật nuôi với rô-bốt trong quá trình rô-bốt hoạt động.
- Sản phẩm này chỉ dùng để lau sàn trong môi trường gia đình. Không sử dụng sản phẩm này ngoài trời, trên các bề mặt không phải sàn hoặc trong môi trường thương mại hoặc công nghiệp.
- Nếu bộ chuyển đổi bị hỏng hoặc đứt, hãy ngừng sử dụng ngay lập tức và liên hệ với bộ phận dịch vụ hậu mãi.
- Không sử dụng rô-bốt ở khu vực cao hơn mặt đất mà không có hàng rào bảo vệ.
- Không đặt rô-bốt ở tư thế lộn ngược. Không sử dụng nắp LDS, nắp rô-bốt hoặc bộ giảm chấn làm tay cầm cho rô-bốt.
- Sử dụng rô-bốt trong môi trường có nhiệt độ xung quanh từ trên 0°C đến dưới 40°C. Đảm bảo không có chất lỏng hoặc chất dính trên sàn.
- Nhặt gọn mọi loại dây cáp trên sàn trước khi sử dụng rô-bốt để ngăn rô-bốt kéo lê dây cáp trong khi làm sạch.

## Thông tin an toàn

- Loại bỏ các vật dụng nhỏ hoặc dễ vỡ khỏi sàn nhà để rô-bốt không va vào và làm hỏng các vật dụng đó.
- Để tránh bị kéo lê làm hư hỏng hoặc tổn hại, hãy dọn sạch mọi vật không cố định khỏi sàn và tháo dây cáp hoặc dây nguồn nằm trong lộ trình lau dọn trước khi vận hành thiết bị.
- Không để tóc, ngón tay và các bộ phận cơ thể gần lỗ hút của rô-bốt.
- Đặt dụng cụ vệ sinh là chổi ngoài tầm với của trẻ em.
- Không đặt trẻ em, vật nuôi hoặc bất kỳ vật dụng nào lên trên rô-bốt bất kể rô-bốt đang đứng yên hay di chuyển.
- Không sử dụng rô-bốt để vệ sinh bất kỳ đồ vật đang cháy nào. Không sử dụng rô-bốt để hút chất lỏng dễ cháy hoặc dễ bắt lửa, khí ăn mòn hoặc axit hoặc dung môi chưa pha loãng.
- Không sử dụng thiết bị để hút các vật cứng hoặc sắc nhọn. Không sử dụng thiết bị để hút các vật như đá, mảnh giấy lớn hoặc bất kỳ vật dụng nào có thể làm tắc máy.
- Đảm bảo rằng rô-bốt đã tắt và rút phích cắm của để sạc trước khi vệ sinh hoặc tiến hành bảo trì.
- Không dùng khăn ướt để lau hoặc dùng bất kỳ chất lỏng nào để rửa rô-bốt và để sạc. Cần phải làm khô hoàn toàn các bộ phận có thể rửa được trước khi lắp đặt và sử dụng các bộ phận này.
- Đảm bảo tắt rô-bốt khi vận chuyển và để trong bao bì đóng gói ban đầu nếu còn.
- Vui lòng sử dụng sản phẩm này theo hướng dẫn trong Hướng dẫn sử dụng. Người dùng tự chịu trách nhiệm nếu có bất kỳ tổn thất hoặc hư hỏng nào phát sinh do sử dụng sản phẩm sai cách.

## Thông tin an toàn

### Pin và Sạc

- **CẢNH BÁO:** Không được sạc lại pin không thể sạc.
- Không sử dụng bất kỳ pin, bộ chuyển đổi hoặc đế sạc của bên thứ ba nào. Chỉ sử dụng thiết bị với bộ nguồn RCFA0301.
- Không tự ý tháo rời, sửa chữa, hay sửa đổi pin hoặc đế sạc.
- Không đặt đế sạc gần nguồn nhiệt.
- Không dùng khăn ướt hoặc tay ướt để lau hoặc làm sạch các điểm tiếp xúc sạc của đế.
- Không thải bỏ pin cũ sai cách. Pin không dùng phải được loại bỏ tại một cơ sở tái chế thích hợp.
- Nếu không sử dụng rô-bốt trong thời gian dài, hãy sạc đầy pin, sau đó tắt và bảo quản ở nơi khô ráo, thoáng mát. Sạc lại rô-bốt ít nhất một lần mỗi 3 tháng để tránh việc xả pin quá mức.
- Chỉ các kỹ thuật viên có trình độ hoặc dịch vụ hỗ trợ sau bán hàng mới có thể thay thế pin trong sản phẩm này.

### Thông tin an toàn laser

- Cảm biến laser trong sản phẩm này đáp ứng Tiêu chuẩn IEC 60825- 1:2014/EN 60825- 1:2014/ A11:2021 dành cho sản phẩm laser Loại 1. Vui lòng tránh tiếp xúc trực tiếp bằng mắt với cảm biến trong quá trình sử dụng.

SẢN PHẨM LASER LOẠI 1

SẢN PHẨM LASER DÀNH CHO NGƯỜI TIỂU DÙNG

EN 50689:2021

## VI Thông tin an toàn

 Chỉ sử dụng trong nhà

 Đọc hướng dẫn sử dụng

Bằng văn bản này, Dreame Trading (Tianjin) Co., Ltd. tuyên bố loại thiết bị vô tuyến RLF41GA tuân thủ Chỉ thị 2014/53/EU. Xem toàn văn tuyên bố tuân thủ EU theo địa chỉ: <https://global.dreame.tech>

Để xem hướng dẫn điện tử chi tiết, vui lòng truy cập <https://global.dreame.tech/pages/user-manuals-and-faqs>

## A Tổng Quan Về Sản Phẩm

### Rô-bốt

- Nút Nguồn/Lau dọn
    - Nhấn giữ trong 3 giây để bật hoặc tắt
    - Nhấn để bắt đầu lau dọn sau khi bật rô-bốt
  - Nút trạm sạc/Lau dọn tập trung 
    - Nhấn để đưa rô-bốt trở lại để sạc
    - Nhấn và giữ trong 3 giây để bắt đầu chế độ lau dọn tập trung
- Đèn báo trạng thái nút
- Màu trắng: Đã vệ sinh hoặc dọn dẹp xong
  - Màu cam nhấp nháy: Lỗi
  - Màu trắng nhấp chậm: Rô-bốt đang sạc khi nguồn pin không ở mức thấp

### Lưu ý:

- Nhấn bất kỳ nút nào trên rô-bốt để tạm dừng khi rô-bốt đang lau dọn hoặc quay lại để sạc.
  - Nhấn và giữ nút nguồn và nút trạm sạc trong 3 giây để đặt lại Wi-Fi.
  - Có thể bật/tắt Khóa trẻ em trên ứng dụng Dreamehome.
- Nắp LDS
  - Cảm biến khoảng cách laser (LDS)
  - Bộ giảm chấn
  - Chổi bên
  - Bánh xe chính
  - Cảm biến chống rơi
  - Bánh xe đa hướng
  - Các chốt khoá khung bảo vệ chổi
  - Bánh xe chính
  - Chổi chính

- Khung bảo vệ chổi
- Nút đặt lại
  - Nhấn giữ trong 3 giây để khôi phục cài đặt gốc
- Điểm tiếp xúc sạc
- Khay chứa nước 2 trong 1 kèm Hộp chứa bụi
- Cảm biến quay lại trạm sạc
- Cụm lau nhà

### Hình A-1

### Khay chứa nước 2 trong 1 kèm Hộp chứa bụi

- Giá đỡ bộ lọc
- Bộ lọc HEPA
- Nắp lỗ nước vào
- Lỗ nước vào
- Kẹp nhà

### Hình A-2

### Cụm lau nhà

- Giá đỡ giẻ lau sàn
- Kẹp nhà
- Mặt gắn giẻ lau
- Giẻ lau sàn

### Hình A-3

### Để sạc

- Điểm tiếp xúc sạc
- Khu vực truyền tín hiệu
- Cổng nguồn

### Hình A-4

## B Thu dọn nhà cửa

- Trước khi lau sàn, vui lòng cất những món đồ rải rác trên sàn, hàng để vỡ, đồ vật giá trị hoặc có khả năng gây nguy hiểm. Đồng thời thu dọn dây cáp, đồ chơi, vật cứng và các vật sắc nhọn ra khỏi mặt đất để tránh làm vướng rô-bốt hoặc bị va chạm gây trầy xước, va đập, hư hỏng sàn phẩm.
- Trước khi lau dọn, hãy đặt rào chắn vật lý ở mép cầu thang để đảm bảo rô-bốt vận hành an toàn và trơn tru.
- Mở cửa phòng cần lau dọn và xếp đồ đạc vào đúng chỗ để có nhiều không gian hơn.
- Không đứng phía trước rô-bốt, bậc cửa, hành lang hoặc những nơi chật hẹp để tránh việc rô-bốt không nhận diện được khu vực cần lau dọn.

### Lưu ý:

- Khi vận hành rô-bốt lần đầu tiên, hãy đi theo khi rô-bốt làm sạch để kịp thời loại bỏ mọi chướng ngại vật.
- Không để rô-bốt hút các vật cứng như đá, bi thép, các mảnh đồ chơi hoặc các vật sắc nhọn như phế thải xây dựng, mảnh kính vỡ và đinh, nếu không có thể làm trầy xước sàn nhà.

### Hình B

## C Trước khi sử dụng

### 1. Đặt đế sạc và kết nối với ổ cắm điện

Bóc lớp băng dính hai mặt ở phía dưới đế sạc. Đặt đế sạc ở vị trí thoáng nhất có thể với tín hiệu Wi-Fi tốt. Chừa đủ khoảng trống như trong hình và loại bỏ mọi vật dụng trong vùng tô bóng. Cắm bộ chuyển đổi vào đế sạc và cắm vào ổ điện.

#### Lưu ý:

- Loại bỏ mọi vật thể trong vòng 1,5 m ở phía trước và 0,5 m ở hai bên của đế sạc.
- Không đặt đế sạc ở khu vực có ánh sáng mặt trời chiếu trực tiếp hoặc nơi các đồ vật khác có thể chặn tín hiệu, vì điều này có thể cản trở rô-bốt quay trở lại đế sạc.
- Nên đặt đế sạc trên sàn gạch hoặc sàn đá cẩm thạch để tránh vết nước từ sàn gỗ hoặc thảm.

### 2. Tháo vỏ bọc rô-bốt và lắp chổi bên

### 3. Kết nối với Ứng dụng Dreamehome

- Nhấn và giữ nút nguồn trên rô-bốt trong 3 giây để bật máy. Quét mã QR trên rô-bốt hoặc tìm kiếm "Dreamehome" trong cửa hàng ứng dụng để tải xuống và cài đặt ứng dụng.
- Mở ứng dụng Dreamehome, bấm "Quét mã QR để kết nối" và quét lại mã QR đó trên rô-bốt để thêm thiết bị. Vui lòng làm theo lời nhắc để hoàn tất kết nối Wi-Fi.

#### ① Mã QR

#### ② Đèn báo Wi-Fi

- Nhấp nháy: Đã được kết nối / Đang kết nối
- Bật: Đã kết nối

#### Lưu ý:

- Chỉ hỗ trợ Wi-Fi 2,4 GHz.
- Để đặt lại Wi-Fi, hãy lặp lại bước (2) rồi làm theo lời nhắc để hoàn tất kết nối Wi-Fi.
- Để ngắt kết nối thiết bị khỏi mạng Wi-Fi, nhấn và giữ nút đặt lại trên rô-bốt trong 3 giây.
- Do phần mềm ứng dụng có các bản nâng cấp nên hoạt động thực tế có thể khác với hướng dẫn trong hướng dẫn sử dụng này. Vui lòng làm theo hướng dẫn dựa trên phiên bản ứng dụng hiện tại.

### 4. Sạc Rô-bốt

Khi đặt rô-bốt, hãy căn chỉnh các điểm tiếp xúc sạc của rô-bốt với các điểm tiếp xúc sạc của đế sạc, rô-bốt sẽ tự động bật và bắt đầu sạc.

Sau khi rô-bốt đã sạc đầy pin, đèn báo trạng thái trên rô-bốt và đế sạc sẽ sáng trong 10 phút rồi mờ dần.

**Lưu ý:** Bạn nên sạc đầy rô-bốt ở lần đầu sử dụng. Khi không thể bật rô-bốt lúc pin đã cạn kiệt, hãy tự kết nối rô-bốt với đế sạc để sạc.

#### Hình C-1 Hình C-4

## D Cách Sử Dụng

### Bật/Tắt

Nhấn và giữ nút nguồn trong 3 giây để bật rô-bốt. Đèn báo nguồn sẽ sáng. Đặt rô-bốt lên đế sạc, rô-bốt sẽ tự động bật và bắt đầu sạc. Để tắt rô-bốt, di chuyển rô-bốt ra khỏi đế sạc và nhấn giữ nút nguồn trong 3 giây.

### Thiết lập bản đồ nhanh

Sau khi định cấu hình mạng lần đầu tiên, hãy làm theo hướng dẫn trên ứng dụng để nhanh chóng thiết lập bản đồ. Rô-bốt sẽ bắt đầu lập bản đồ mà không lau dọn. Khi rô-bốt quay trở lại đế sạc, quá trình lập bản đồ đã hoàn tất và bản đồ sẽ được lưu tự động.

### Bắt đầu làm sạch

Nhấn Nút nguồn để bắt đầu lau dọn sau khi bật rô-bốt. Rô-bốt sẽ vạch ra lộ trình chính xác, lau dọn theo phương pháp dọc theo các cạnh và tường, sau đó hoàn tất bằng việc lau dọn từng phòng theo hình chữ S để đảm bảo lau sạch triệt để.

**Lưu ý:** Rô-bốt nên khởi hành từ đế sạc trước khi lau dọn. Không di chuyển đế sạc trong khi rô-bốt đang lau dọn. Điều này đảm bảo rằng rô-bốt quay trở lại đế sạc một cách mượt mà.

### Tạm dừng/Ngủ

Khi rô-bốt đang chạy, nhấn nút bất kỳ để tạm dừng. Nếu rô-bốt bị tạm dừng hơn 10 phút sẽ tự động chuyển sang chế độ ngủ. Tất cả đèn báo trên rô-bốt sẽ tắt. Nhấn nút bất kỳ trên rô-bốt hoặc sử dụng ứng dụng để đánh thức rô-bốt.

**Lưu ý:** Nếu rô-bốt đang tạm dừng, khi đưa về để sạc thì nhiệm vụ lau dọn gần nhất sẽ kết thúc.

### Tự động tiếp tục lau dọn

Nếu pin quá yếu, rô-bốt sẽ tự động quay trở lại để sạc để sạc. Sau khi sạc đến mức pin thích hợp, rô-bốt sẽ tiếp tục các công việc lau dọn đang dở.

**Lưu ý:** Để sử dụng chức năng này, vui lòng cho phép trong ứng dụng.

### Chế độ Không làm phiền (DND)

Khi rô-bốt được đặt ở chế độ Không làm phiền (DND), rô-bốt sẽ ngừng quá trình tiếp tục dọn dẹp. Chế độ DND bị tắt theo mặc định gốc. Bạn có thể sử dụng ứng dụng để bật chế độ DND hoặc chỉnh sửa khung giờ DND. Khung giờ DND mặc định từ 22:00 giờ đêm-8:00 giờ sáng.

**Lưu ý:**

- Các nhiệm vụ dọn dẹp đã lên lịch vẫn sẽ được thực hiện như thường trong khung giờ bật chế độ DND.
- Rô-bốt sẽ tiếp tục lau dọn từ vị trí đã dừng lại sau khi kết thúc chế độ DND.

### Chế độ lau dọn tập trung

Khi rô-bốt đang ở trạng thái đợi, hãy nhấn và giữ nút  trong 3 giây để bật chế độ lau dọn tập trung. Ở chế độ này, rô-bốt làm sạch khu vực hình vuông xung quanh có diện tích 1,5 x 1,5 mét và quay trở lại điểm xuất phát sau khi hoàn tất chế độ lau dọn tập trung.

### Khởi động lại rô-bốt

Nếu rô-bốt ngừng phản hồi hoặc không thể tắt, nhấn và giữ nút nguồn trong 10 giây để buộc tắt rô-bốt. Tiếp đó, bấm và giữ nút nguồn trong 3 giây để bật lại rô-bốt.

### Sử dụng Chức năng lau

**Lưu ý:** khuyến nghị nên hút bụi ít nhất ba lần trước lần lau đầu tiên để đạt hiệu quả lau dọn tốt hơn.

1. Nhấn chốt nhà để tháo khay chứa nước 2 trong 1 cùng với hộp chứa bụi.
2. Mở nắp lỗ nước vào, đổ thêm nước và đóng chặt nắp.

**Lưu ý:**

- Không sử dụng chất tẩy rửa hoặc chất khử trùng.
  - Không đổ nước nóng vào khay chứa nước vì có thể làm khay chứa nước bị cong vênh.
3. Làm ẩm giẻ lau sàn và vắt kiệt nước. Tiến hành lắp giẻ lau sàn như minh họa trong sơ đồ.

4. Lắp đặt lại khay chứa nước 2 trong 1 cùng với hộp chứa bụi và cụm lau nhà về phía sau như hình minh họa cho đến khi khớp vào vị trí. Nhấn nút nguồn hoặc sử dụng ứng dụng để bắt đầu lau dọn.

**Lưu ý:**

- Không nên sử dụng chức năng lau đối với thảm.
  - Sử dụng ứng dụng để điều chỉnh độ ẩm giẻ lau sàn theo nhu cầu.
5. Khi robot quay lại sạc sau khi lau dọn, hãy tháo giá đỡ giẻ lau sàn và vệ sinh giẻ lau sàn để tránh nấm mốc hoặc mùi hôi.

**Lưu ý:**

- Rửa giẻ lau sàn sau mỗi lần sử dụng và thường xuyên đổ hết nước chứa sử dụng trong khay chứa nước.
- Tháo cụm giẻ lau sàn khi không lau.

### Hình D-1 Hình D-5

## E Bảo dưỡng định kỳ

### Các bộ phận

Để đảm bảo rô-bốt luôn ở tình trạng tốt, bạn nên tham khảo cách sử dụng phụ kiện trong ứng dụng hoặc bảng sau để bảo dưỡng định kỳ.

Bộ phận	Tần suất bảo trì	Thời gian thay thế
Giẻ lau sàn	Sau mỗi lần sử dụng	3 đến 6 tháng một lần
Chổi chính	2 tuần một lần	6 đến 12 tháng một lần
Chổi bên		3 đến 6 tháng một lần
Bộ lọc hộp chứa bụi		
Khu vực truyền tín hiệu của đế sạc	Mỗi tháng một lần	/
Điểm tiếp xúc sạc		
Cảm biến khoảng cách laser (LDS)		
Cảm biến quay lại trạm sạc		
Bộ giảm chấn		
Mặt bên dưới của rô-bốt		
Bánh xe đa hướng		
Cảm biến chống rơi		

Bộ phận	Tần suất bảo trì	Thời gian thay thế
Hộp chứa bụi	Vệ sinh khi cần thiết	/
Bánh xe chính		
Khay chứa nước		

**Lưu ý:** Tần suất thay thế sẽ tùy theo cách bạn sử dụng rô-bốt. Nếu xảy ra trường hợp ngoại lệ do hoàn cảnh đặc biệt thì bạn nên thay thế các bộ phận.

### Chổi chính

1. Nhấn chốt khoá khung bảo vệ chổi vào trong để tháo khung bảo vệ chổi và nhấc chổi ra khỏi rô-bốt.
2. Sử dụng dụng cụ vệ sinh thích hợp để loại bỏ bất kỳ sợi lông hoặc tóc nào bị vướng vào chổi chính. Sau đó lắp lại chổi vào và nhấn vào khung bảo vệ chổi để khóa cố định chổi.

#### Hình E-1

### Chổi bên

Tháo và vệ sinh chổi bên.

#### Hình E-2

### Bánh xe đa hướng

Sử dụng dụng cụ vệ sinh thích hợp để loại bỏ bất kỳ sợi lông hoặc tóc nào bị vướng vào bánh xe đa hướng.

#### Hình E-3

### Khay chứa nước 2 trong 1 kèm Hộp chứa bụi

1. Nhấn chốt nhả để tháo khay chứa nước 2 trong 1 cùng với hộp chứa bụi, sau đó đổ hết nước trong khay chứa nước.
2. Tháo nắp hộp chứa bụi rồi đổ bụi trong hộp chứa bụi.
3. Mở giá đỡ bộ lọc để tháo bộ lọc HEPA ra và gõ nhẹ vào bộ lọc HEPA.

**Lưu ý:** Không cố làm sạch bộ lọc bằng bàn chải, ngón tay hoặc vật sắc nhọn để tránh hư hỏng.

4. Rửa hộp chứa bụi và bộ lọc HEPA bằng nước rồi để khô hoàn toàn trước khi lắp lại.

**Lưu ý:**

- Không rửa các bộ phận bên ngoài hộp chứa bụi. Nếu có vết nước, hãy lau khô trước khi lắp lại.
- Chỉ rửa hộp chứa bụi và bộ lọc bằng nước sạch. Không sử dụng bất kỳ chất tẩy rửa gì.
- Chỉ sử dụng hộp chứa bụi và bộ lọc khi đã khô hoàn toàn.

#### Hình E-4

### Giẻ lau sàn

1. Tháo cụm lau nhà và kéo giẻ lau sàn ra khỏi giá đỡ giẻ lau sàn.
2. Tháo và vệ sinh giẻ lau sàn chỉ bằng nước, sau đó để khô hoàn toàn trước khi lắp lại.

#### Hình E-5

### Cảm biến cửa rô-bốt

Lau cảm biến cửa rô-bốt bằng vải mềm khô như trong hình dưới đây:

1. Cảm biến khoảng cách laser (LDS)
2. Bộ giảm chấn
3. Cảm biến quay lại trạm sạc
4. Cảm biến chống rơi

**Lưu ý:** Vải ướt có thể làm hỏng các bộ phận nhạy cảm bên trong rô-bốt và để sạch. Vui lòng sử dụng vải khô để vệ sinh.

#### Hình E-6

### Điểm tiếp xúc sạc và Khu vực truyền tín hiệu

Làm sạch các điểm tiếp xúc sạc và khu vực truyền tín hiệu bằng vải khô mềm.

#### Hình E-7

### Pin

Rô-bốt sử dụng bộ pin lithium-ion hiệu suất cao. Đảm bảo sạc đầy pin để sử dụng hàng ngày nhằm duy trì hiệu suất tối ưu của pin. Nếu không sử dụng trong thời gian dài, hãy tắt nguồn và cất rô-bốt ở nơi thoáng mát. Để tránh gây hư hỏng do hết pin quá lâu, hãy sạc rô-bốt ít nhất ba tháng một lần.

## Xử Lý Sự Cố

Vấn đề	Biện Pháp Xử Lý
Không bắt được rô-bốt.	<ul style="list-style-type: none"> <li>Pin yếu. Sạc lại cho rô-bốt trên để sạc rồi thử lại.</li> <li>Nhiệt độ pin quá thấp hoặc quá cao. Khuyến nghị vận hành thiết bị ở nhiệt độ từ 32°F (0°C) đến 104°F (40°C).</li> </ul>
Sạc rô-bốt không vào.	<ul style="list-style-type: none"> <li>Để sạc chưa được cắm điện, vui lòng đảm bảo cắm cả hai đầu của bộ chuyển đổi đúng cách.</li> <li>Nếu tiếp xúc giữa các điểm tiếp xúc sạc trên đế sạc và rô-bốt kém, vui lòng vệ sinh các điểm tiếp xúc sạc.</li> </ul>
Rô-bốt không kết nối được với Wi-Fi.	<ul style="list-style-type: none"> <li>Mật khẩu mạng Wi-Fi không chính xác. Đảm bảo nhập đúng mật khẩu sử dụng để kết nối với mạng Wi-Fi.</li> <li>Rô-bốt không hỗ trợ kết nối Wi-Fi 5 GHz. Đảm bảo đã kết nối rô-bốt với mạng Wi-Fi 2,4 GHz.</li> <li>Tín hiệu Wi-Fi yếu. Đảm bảo rô-bốt đang ở trong khu vực có vùng phủ sóng Wi-Fi tốt.</li> <li>Rô-bốt có thể chưa sẵn sàng để thiết lập cấu hình. Vui lòng thoát ra và vào lại ứng dụng, sau đó thử lại theo hướng dẫn.</li> </ul>

Vấn đề	Biện Pháp Xử Lý
Robot không thể quay trở lại để sạc.	<ul style="list-style-type: none"> <li>Lối đi quay về sạc bị chặn, ví dụ: cửa đóng.</li> <li>Đế sạc bị ngắt điện hoặc bị di chuyển khi rô-bốt không có ở đó. Vui lòng kết nối đế sạc với nguồn điện hoặc đặt rô-bốt lên trên đế sạc để sạc.</li> <li>Quá nhiều vật cản xung quanh đế sạc. Đặt đế sạc tại khu vực thoáng hơn.</li> <li>Di chuyển rô-bốt có thể khiến rô-bốt phải tự định vị lại và tạo lại bản đồ nếu định vị không thành công. Nếu ở quá xa đế sạc, rô-bốt không tự quay lại được và khi đó bạn cần đặt thủ công rô-bốt lên đế sạc.</li> <li>Lau khu vực truyền tín hiệu trên đế sạc để loại bỏ bụi hoặc mảnh vụn.</li> </ul>
Rô-bốt bị kẹt phía trước đế sạc và không quay lại được để sạc.	<ul style="list-style-type: none"> <li>Kiểm tra xem có đủ không gian ở hai bên hoặc đằng trước đế sạc hay không để tránh cho rô-bốt không bị chặn đường.</li> <li>Rô-bốt có thể bị trượt nếu khu vực sàn phía trước đế sạc quá ẩm ướt. Nếu vậy, hãy làm sạch lượng nước thừa trước khi thử lại.</li> <li>Bạn nên di chuyển đế sạc đến một nơi khác và thử lại.</li> </ul>

## Xử Lý Sự Cố

Vấn đề	Biện Pháp Xử Lý
Không tắt được rô-bốt.	<ul style="list-style-type: none"> <li>Không thể tắt rô-bốt khi đang sạc. Bạn nên di chuyển rô-bốt ra khỏi đế sạc, sau đó nhấn và giữ nút nguồn trong 3 giây để tắt rô-bốt.</li> <li>Nếu không thể tắt rô-bốt bằng cách thực hiện bước 1, nhấn và giữ nút nguồn trong 10 giây để buộc tắt rô-bốt. Nếu vẫn không tắt được, vui lòng liên hệ với dịch vụ hỗ trợ sau bán hàng.</li> </ul>
Tốc độ sạc chậm.	<ul style="list-style-type: none"> <li>Mất khoảng 4,5 giờ để sạc đầy rô-bốt khi pin yếu.</li> <li>Nếu vận hành rô-bốt ở khoảng nhiệt độ ngoài mức quy định, tốc độ sạc sẽ tự động chậm lại để kéo dài tuổi thọ của pin.</li> <li>Các điểm tiếp xúc sạc trên cả rô-bốt và đế sạc có thể bị bẩn, vui lòng lau bằng vải khô.</li> </ul>
Rô-bốt ngày một ồn khi đang hoạt động.	<ul style="list-style-type: none"> <li>Kiểm tra xem bộ lọc hộp chứa bụi có bị tắc không. Nếu có, hãy vệ sinh hoặc thay bộ lọc.</li> <li>Vật cứng có thể mắc vào chổi chính hoặc hộp chứa bụi. Kiểm tra và loại bỏ mọi vật cứng.</li> <li>Chổi chính hoặc chổi bên có thể bị rối. Kiểm tra và loại bỏ mọi vật lạ.</li> <li>Chuyển chế độ hút sang Tiêu chuẩn hoặc Yên tĩnh.</li> </ul>
Rô-bốt di chuyển không theo lộ trình đã định.	<ul style="list-style-type: none"> <li>Nên thu dọn các đồ vật như dây nguồn và dép đi trong nhà trước khi sử dụng rô-bốt.</li> <li>Bề mặt trơn ướt có thể khiến bánh xe chính bị trơn trượt. Nên làm khô tất cả những nơi ẩm ướt trước khi sử dụng rô-bốt.</li> </ul>

Vấn đề	Biện Pháp Xử Lý
Rô-bốt bỏ qua các phòng cần lau dọn.	<ul style="list-style-type: none"> <li>Hãy đảm bảo mở cửa các phòng cần lau dọn.</li> <li>Kiểm tra xem bậc cửa có cao hơn 2 cm hay không. Rô-bốt không thể trèo qua bậc cửa hoặc bậc thang cao.</li> <li>Vị trí trước cửa phòng cần vệ sinh có thể ẩm ướt, trơn trượt khiến rô-bốt trượt bánh và hoạt động không bình thường. Vui lòng làm khô sàn nhà trước khi sử dụng rô-bốt.</li> </ul>
Rô-bốt không tiếp tục dọn dẹp sau khi sạc.	<ul style="list-style-type: none"> <li>Đảm bảo không đặt rô-bốt ở chế độ Không làm phiền (DND) để tránh rô-bốt không thể tiếp tục lau dọn.</li> <li>Rô-bốt sẽ không tiếp tục lau dọn sau khi bạn tự đưa rô-bốt vào đế sạc hay điều khiển rô-bốt để sạc thông qua ứng dụng hoặc nút bấm .</li> </ul>
Không có hoặc chỉ có ít nước chảy ra từ khay chứa nước.	<ul style="list-style-type: none"> <li>Kiểm tra xem có nước bên trong khay chứa nước không.</li> <li>Làm sạch giẻ lau sàn nếu bị bẩn.</li> <li>Bạn cần đảm bảo rằng giẻ lau sàn và giá đỡ giẻ lau sàn được lắp đúng theo Hướng dẫn sử dụng.</li> </ul>
Rô-bốt bị lỗi.	<ul style="list-style-type: none"> <li>Tắt rô-bốt và kích hoạt lại.</li> </ul>

## Xử Lý Sự Cố

Vấn đề	Biện Pháp Xử Lý
Rô-bốt không còn làm sạch hiệu quả hoặc để lại bụi.	<ul style="list-style-type: none"><li>Hộp chứa bụi đã đầy. Làm sạch hộp chứa bụi.</li><li>Bộ lọc bị tắc. Làm sạch hộp chứa bụi.</li><li>Có dị vật mắc vào chổi chính. Làm sạch hộp chứa bụi.</li></ul>
Rô-bốt không thực hiện dọn dẹp theo lịch trình.	<ul style="list-style-type: none"><li>Rô-bốt sắp hết pin. Rô-bốt sẽ không bắt đầu tính năng dọn dẹp theo lịch trình trừ khi còn ít nhất 15% pin.</li></ul>

Để được hỗ trợ thêm, hãy liên hệ với chúng tôi qua <https://global.dreametech.com>.

## Thông số kỹ thuật

### Rô-bốt

Kiểu máy	RLF41GA
Thời gian sạc	Xấp xỉ 4,5 giờ
Điện áp định mức	14,4 V ===
Công suất định mức	45 W
Tần suất hoạt động	2400–2483,5 MHz
Công suất đầu ra tối đa	< 20 dBm

Trong điều kiện sử dụng bình thường, cần để thiết bị này cách ăng-ten và cơ thể người dùng ít nhất 20 cm.

### Bộ pin lithium-ion có thể sạc lại

Kiểu máy	C1251A6
Loại	Li-ion
Số lượng	1
Dung lượng định mức	2,95 Ah

### Đế sạc

Kiểu máy	RCFA0301
Đầu vào định mức	20 V === 1 A
Công suất đầu ra định mức	20 V === 1 A

### Bộ chuyển đổi

Nhà sản xuất	Shenzhen CHANZEHO Technology Co., Limited
Kiểu máy	CZH024N200100EUWA1
Đầu vào định mức	100–240 V ~ 50/60 Hz 0,8 A tối đa
Công suất đầu ra định mức	20 V === 1 A 20 W
Hiệu suất hoạt động trung bình	85,47%
Hiệu suất khi tải thấp (10%)	81,30%
Mức tiêu thụ điện khi không tải	<0,1 W

## Tháo Bỏ và Xử Lý Pin

Pin lithium-ion tích hợp có chứa các chất nguy hiểm cho môi trường. Trước khi tháo bỏ pin, hãy đảm bảo việc tháo pin do các kỹ thuật viên có trình độ thực hiện và thải bỏ tại một cơ sở tái chế thích hợp.

- Bạn cần tháo pin ra khỏi thiết bị trước khi vứt bỏ;
- Thiết bị phải được ngắt khỏi nguồn điện chính khi tháo pin;
- Pin phải được xử lý an toàn.

### THẬN TRỌNG:

Trước khi tháo pin, hãy ngắt nguồn điện và dùng pin hết mức có thể.

Pin không dùng phải được loại bỏ tại một cơ sở tái chế thích hợp.

Không để pin tiếp xúc với môi trường nhiệt độ cao để tránh nguy cơ cháy nổ.

Nếu quá lạm dụng, chất lỏng có thể bị rò ra khỏi pin. Nếu không may tiếp xúc, xả dưới nước và điều trị y tế.

### Hướng dẫn tháo:

1. Lật ngược rô-bốt, dùng dụng cụ thích hợp để tháo các vít ở mặt sau của rô-bốt rồi tháo nắp.
2. Rút phích cắm các cực giữa pin và bo mạch PCB để tháo pin.

## Thông Tin Rác Thải Thiết Bị Điện Và Điện Tử (WEEE)



Tất cả các sản phẩm mang biểu tượng này đều là chất thải thiết bị điện và điện tử (WEEE theo chỉ thị 2012/19/EU) không được trộn lẫn với rác thải sinh hoạt chưa được phân loại. Thay vào đó, bạn nên bảo vệ sức khỏe con người và môi trường bằng cách giao thiết bị thải bỏ của mình cho điểm thu gom được chỉ định để tái chế chất thải thiết bị điện và điện tử, được chỉ định bởi chính phủ hoặc chính quyền địa phương. Việc thải bỏ và tái chế đúng cách sẽ giúp ngăn ngừa các hậu quả tiêu cực tiềm ẩn đối với môi trường và sức khỏe con người. Vui lòng liên hệ với đơn vị lắp đặt hoặc chính quyền địa phương để biết thêm thông tin về địa điểm cũng như các điều khoản và điều kiện của các điểm thu gom này.

## ข้อมูลด้านความปลอดภัย

เพื่อหลีกเลี่ยงการเกิดไฟฟ้าช็อต ไฟไหม้ หรือการบาดเจ็บที่เกิดจากการใช้เครื่องอย่างไม่เหมาะสม โปรดอ่านคู่มือการใช้งานอย่างละเอียดก่อนใช้เครื่อง และเก็บไว้เพื่อใช้ดูในอนาคต

### ข้อจำกัดในการใช้งาน

- เด็กอายุต่ำกว่า 8 ปี หรือบุคคลที่มีความบกพร่องทางร่างกาย ประสาทสัมผัส สติปัญญา หรือประสบการณ์หรือความรู้จำกัด ไม่ควรใช้ผลิตภัณฑ์นี้ โดยไม่ได้รับการดูแลจากพ่อแม่หรือผู้ปกครองเพื่อให้แน่ใจว่าการทำงานปลอดภัยและเพื่อหลีกเลี่ยงความเสี่ยงใดๆ ที่อาจเกิดขึ้น ห้ามเด็กทำความสะอาดและบำรุงรักษาโดยไม่มีผู้ดูแล
- ห้ามเด็กเล่นกับผลิตภัณฑ์นี้ ตรวจสอบให้แน่ใจว่าเด็กและสัตว์เลี้ยงอยู่ห่างจากหุ่นยนต์ในระยะที่ปลอดภัยในขณะที่หุ่นยนต์กำลังทำงาน
- ผลิตภัณฑ์นี้ใช้สำหรับการทำความสะอาดพื้นในบ้านเท่านั้น ห้ามใช้งานกลางแจ้ง บนพื้นผิวที่ไม่ใช่พื้น หรือในเชิงพาณิชย์หรืออุตสาหกรรม
- หากอะแดปเตอร์เสียหายหรือชำรุด ให้หยุดใช้งานทันที และติดต่อฝ่ายบริการหลังการขาย
- ห้ามใช้หุ่นยนต์ในบริเวณที่อยู่เหนือระดับพื้นดินโดยไม่มีสิ่งกีดขวางป้องกันเอาไว้
- ห้ามวางหุ่นยนต์กลับด้าน ห้ามใช้ฝาครอบ LDS ฝาปิดหุ่นยนต์ หรือกันชนเป็นที่จับสำหรับหุ่นยนต์
- ใช้หุ่นยนต์ในสภาพแวดล้อมที่มีอุณหภูมิแวดล้อมสูงกว่า 0°C และต่ำกว่า 40°C ตรวจสอบให้แน่ใจว่าไม่มีของเหลวหรือสารเหนียวบนพื้น
- เก็บสายเคเบิลออกจากพื้นก่อนใช้หุ่นยนต์เพื่อป้องกันไม่ให้เกิดการลากสายเคเบิลในขณะที่ทำความสะอาด
- นำสิ่งของที่เปราะบางหรือมีขนาดเล็กออกจากพื้นเพื่อป้องกันไม่ทำให้หุ่นยนต์ชนและสร้างความเสียหาย
- เพื่อป้องกันความเสียหายหรืออันตรายจากการลากให้นำสิ่งกีดขวางออกจากพื้น และถอดสายเคเบิลหรือสายไฟบนพื้นที่ทำความสะอาดก่อนเปิดใช้งาน

## ข้อมูลด้านความปลอดภัย

- เก็บเส้นผม นิ้วมือ และส่วนอื่นๆ ของร่างกายให้ห่างจากช่องดูดของหุ่นยนต์
- เก็บแปรงปิดฝุ่นให้พ้นมือเด็ก
- ห้ามวางเด็ก สัตว์เลี้ยง หรือสิ่งของใดๆ ไว้บนหุ่นยนต์ ไม่ว่าหุ่นยนต์จะอยู่นิ่งหรือเคลื่อนที่ก็ตาม
- ห้ามใช้หุ่นยนต์ทำความสะอาดวัตถุที่กำลังไหม้ ห้ามใช้หุ่นยนต์หยิบของเหลวที่ไวไฟหรือวัตถุที่ติดไฟได้ ก๊าซที่มีฤทธิ์กัดกร่อน หรือกรดหรือตัวทำละลายที่ไม่มีการเจือปน
- ห้ามดูดวัตถุแข็งหรือมีคม ห้ามใช้อุปกรณ์ในการเก็บวัตถุ เช่น ก้อนหิน กระจาดขี้นใหญ่ หรือสิ่งของใดๆ ที่อาจทำให้อุปกรณ์อุดตัน
- ตรวจสอบให้แน่ใจว่าหุ่นยนต์ปิดอยู่และถอดปลั๊กแท่นชาร์จไฟออกก่อนทำความสะอาดหรือบำรุงรักษา
- อย่าใช้ผ้าเปียกเช็ดหรือน้ำยาใดๆ เพื่อล้างหุ่นยนต์และแท่นชาร์จไฟ ชิ้นส่วนที่ล้างทำความสะอาดได้ต้องถูกทำให้แห้งสนิทก่อนติดตั้งและใช้งาน
- ตรวจสอบให้แน่ใจว่าหุ่นยนต์ปิดอยู่ในขณะที่ทำการขนส่งและหากเป็นไปได้เก็บไว้ในบรรจุภัณฑ์เดิม
- โปรดใช้ผลิตภัณฑ์นี้ตามคำแนะนำในคู่มือการใช้งาน ผู้ใช้ต้องรับผิดชอบต่อความสูญเสียหรือความเสียหายใดๆ ที่เกิดขึ้นจากการใช้ผลิตภัณฑ์นี้อย่างไม่เหมาะสม

## แบตเตอรี่และการชาร์จ

- คำเตือน: ห้ามชาร์จแบตเตอรี่ที่ไม่สามารถชาร์จได้
- ห้ามใช้แบตเตอรี่, อะแดปเตอร์ หรือแท่นชาร์จไฟของบุคคลที่สาม ใช้งานกับชุดจ่ายไฟ RCFA0301 เท่านั้น
- ห้ามพยายามถอดประกอบ ซ่อมแซม หรือดัดแปลงแบตเตอรี่หรือแท่นชาร์จไฟด้วยตัวคุณเอง
- ห้ามวางแท่นชาร์จไฟใกล้กับแหล่งความร้อน
- ห้ามใช้ผ้าเปียกหรือมือที่เปียกเช็ดหรือทำความสะอาดหน้าสัมผัสการชาร์จของแท่นชาร์จไฟ

## ข้อมูลด้านความปลอดภัย

- ห้ามทิ้งแบตเตอรี่เก่าอย่างไม่เหมาะสม ควรทิ้งแบตเตอรี่ที่ไม่ต้องการที่โรงงานรีไซเคิลที่เหมาะสม
- หากไม่ได้ใช้งานหุ่นยนต์เป็นระยะเวลานาน ให้ชาร์ตแบตเตอรี่ให้เต็ม จากนั้น ปิดเครื่องและเก็บในที่แห้งและเย็น ชาร์จหุ่นยนต์อย่างน้อยทุกๆ 3 เดือนเพื่อหลีกเลี่ยงการคายประจุแบตเตอรี่มากเกินไป
- ผลิตภัณฑ์นี้ประกอบด้วยแบตเตอรี่ที่สามารถเปลี่ยนได้โดยช่างผู้ชำนาญหรือบริการหลังการขายเท่านั้น

## ข้อมูลความปลอดภัยของเลเซอร์

- เซ็นเซอร์เลเซอร์ในผลิตภัณฑ์นี้ตรงตามมาตรฐาน IEC 60825-1:2014/EN 60825-1:2014/A11:2021 สำหรับผลิตภัณฑ์เลเซอร์คลาส 1 โปรดหลีกเลี่ยงการสัมผัสกับดวงตาโดยตรงระหว่างการใช้งาน

ผลิตภัณฑ์เลเซอร์คลาส 1

ผลิตภัณฑ์เลเซอร์สำหรับผู้บริโภค

EN 50689:2021

## ข้อมูลด้านความปลอดภัย



สำหรับใช้ในที่ร่มเท่านั้น



อ่านคู่มือการใช้งาน

ด้วยเหตุนี้ Dreame Trading (Tianjin) Co., Ltd. ขอประกาศว่าอุปกรณ์วิทยุประเภท RLF41 GA เป็นไปตามข้อบังคับที่ 2014/53/EU ข้อความฉบับสมบูรณ์ของประกาศความสอดคล้องของสหภาพยุโรปมีอยู่ตามที่อยู่อินเทอร์เน็ตต่อไปนี้: <https://global.dreameotech.com> สำหรับรายละเอียดเพิ่มเติมของคู่มืออิเล็กทรอนิกส์ โปรดไปที่ <https://global.dreameotech.com/pages/user-manuals-and-faqs>

## A ภาพรวมผลิตภัณฑ์

### หุ่นยนต์

1. ปุ่มเปิด/ปิด/ทำความสะอาด
  - กดค้างไว้ 3 วินาทีเพื่อเปิดหรือปิด
  - กดเพื่อเริ่มทำความสะอาดหลังจากเปิดหุ่นยนต์
  2. ปุ่มกลับไปไปที่แท่นชาร์จไฟ/ทำความสะอาดเฉพาะจุด 
  - กดเพื่อส่งหุ่นยนต์กลับไปไปที่แท่นชาร์จไฟ
  - กดค้างไว้ 3 วินาทีเพื่อเริ่มการทำความสะอาดเฉพาะจุด
- ปุ่มไฟแสดงสถานะ
- สีขาวสว่างค้าง: การทำความสะอาดหรือการทำงานเสร็จสิ้นแล้ว
  - สีส้มกะพริบ: เกิดข้อผิดพลาด
  - สีขาวกะพริบเป็นจังหวะ: หุ่นยนต์กำลังชาร์จไฟเมื่อพลังงานแบตเตอรี่ไม่อยู่ในระดับต่ำ

### หมายเหตุ:

- กดปุ่มใดก็ได้บนหุ่นยนต์เพื่อหยุดชั่วคราวในขณะที่หุ่นยนต์กำลังทำความสะอาดหรือกลับไปชาร์จ
  - กดปุ่มเปิด/ปิดและปุ่มกลับไปไปที่แท่นค้างไว้ 3 วินาทีเพื่อรีเซ็ต Wi-Fi
  - ระบบล็อกป้องกันเด็กสามารถเปิดและปิดผ่านทางแอป Dreamehome ได้
3. ฝาครอบ LDS
  4. เซ็นเซอร์เลเซอร์วัดระยะ (LDS)
  5. กันชน
  6. แปรงด้านข้าง
  7. ล้อหลัก
  8. เซ็นเซอร์ป้องกันการตกหล่น
  9. ล้อแบบหมุนรอบทิศทาง
  10. คลิปตัวป้องกันแปรง
  11. ล้อหลัก
  12. แปรงหลัก
  13. ที่ครอบแปรงหลัก

14. ปุ่มรีเซ็ต
- กดค้างไว้ 3 วินาทีเพื่อคืนค่าเป็นการตั้งค่าจากโรงงาน
15. หน้าสัมผัสการชาร์จ
16. ถังเก็บน้ำ 2-in-1 พร้อมกล่องเก็บฝุ่น
17. เซ็นเซอร์กลับแท่น
18. ชุดถูพื้น

### รูป A-1

### ถังเก็บน้ำ 2-in-1 พร้อมกล่องเก็บฝุ่น

1. ที่ยึดตัวกรอง
2. ตัวกรอง HEPA
3. ฝาช่องเติมน้ำเข้า
4. ช่องเติมน้ำเข้า
5. คลิปปลด

### รูป A-2

### ชุดถูพื้น

1. ที่ยึดผ้าถูพื้น
2. คลิปปลด
3. พื้นที่ติดผ้าถูพื้น
4. ผ้าถูพื้น

### รูป A-3

### แท่นชาร์จไฟ

1. หน้าสัมผัสการชาร์จ
2. พื้นที่รับส่งสัญญาณ
3. พอร์ตชาร์จ

### รูป A-4

## B การจัดเตรียมบ้านของคุณ

TH

1. ก่อนทำความสะอาด โปรดย้ายสิ่งของที่ไม่มั่นคงเปราะบาง มีมูลค่า หรือเป็นอันตรายออก และทำความสะอาดสายเคเบิล ผ้า ของเล่น วัตถุของแข็ง และของมีคมบนพื้นเพื่อหลีกเลี่ยงการพันกัน ชิดข่วน หรือกระแทกโดยหุ่นยนต์และทำให้เกิดการสูญเสีย
2. ก่อนการทำความสะอาด ให้วางแผงกันที่ขอบบันไดเพื่อให้หุ่นยนต์ทำงานได้อย่างปลอดภัยและราบรื่น
3. เปิดประตูห้องที่จะทำความสะอาดและวางเฟอร์นิเจอร์ให้เข้าที่เพื่อให้มีพื้นที่ว่างมากขึ้น
4. เพื่อป้องกันไม่ให้หุ่นยนต์ไม่รู้จักพื้นที่ที่ต้องทำความสะอาด อย่ายืนอยู่หน้าหุ่นยนต์ หรือในกรณีประตู โถงทางเดิน หรือที่แคบๆ

### หมายเหตุ:

- เมื่อใช้งานหุ่นยนต์เป็นครั้งแรก ให้เดินตามหุ่นยนต์ไปรอบๆ ขณะทำความสะอาดเพื่อให้สามารถเก็บสิ่งกีดขวางที่อาจเกิดขึ้นได้ทั้งหมด
- ห้ามดูดวัตถุที่เป็นของแข็ง เช่น ก้อนหิน ลูกเหล็ก และชิ้นส่วนของเล่น หรือของมีคม เช่น ขยะก่อสร้าง เศษแก้ว และตะปู มิฉะนั้น อาจทำให้พื้นเป็นรอยได้

### รูป B

## C ก่อนใช้งาน

### 1. วางแท่นชาร์จไฟและเชื่อมต่อกับเต้ารับไฟฟ้า

ลอกเทปกาวสองหน้าที่ด้านหลังของแท่นชาร์จไฟออก วางแท่นชาร์จไฟในตำแหน่งที่เปิดกว้างที่สุดเท่าที่จะเป็นไปได้ซึ่งมีสัญญาณ Wi-Fi ที่ดี เว้นพื้นที่ว่างไว้เพียงพอดูตามที่แสดงในภาพ และนำวัตถุใดๆ ออกจากบริเวณที่แรงจลน์ เสียบอะแดปเตอร์เข้ากับแท่นชาร์จไฟแล้วเสียบเข้ากับเต้ารับ

#### หมายเหตุ:

- เก็บวัตถุใดๆ ที่อยู่ใกล้กว่า 1.5 ม. จากด้านหน้าและ 0.5 ม. จากด้านข้างของแท่นชาร์จไฟ
- อย่าวางแท่นชาร์จไฟในบริเวณที่มีแสงแดดส่องถึงโดยตรงหรือในที่ที่มีวัตถุอื่นบ่งสัญญาณ เนื่องจากอาจทำให้หุ่นยนต์ไม่สามารถกลับไปแท่นชาร์จไฟได้
- เพื่อป้องกันไม่ให้มีคราบน้ำมันพื้นไม้หรือไม่ให้พรมเปียก แนะนำให้วางแท่นชาร์จไฟบนพื้นกระเบื้องหรือพื้นหินอ่อน

### 2. ถอดแผ่นป้องกันออกและติดตั้งแปรงด้านข้าง

### 3. เชื่อมต่อกับแอป Dreamehome

- (1) กดปุ่มเปิดปิดบนหุ่นยนต์ค้างไว้ 3 วินาทีเพื่อเปิดหุ่นยนต์ สแกนคิวอาร์โค้ดบนหุ่นยนต์ หรือค้นหา "Dreamehome" ใน App Store เพื่อดาวน์โหลดและติดตั้งแอป
  - (2) เปิดแอป Dreamehome และ "สแกนคิวอาร์โค้ดเพื่อเชื่อมต่อ" และสแกนคิวอาร์โค้ดเดียวกันบนหุ่นยนต์อีกครั้ง เพื่อเพิ่มอุปกรณ์ โปรดปฏิบัติตามคำแนะนำเพื่อสิ้นสุดการเชื่อมต่อ Wi-Fi
    - ① คิวอาร์โค้ด
    - ② ไฟแสดงสถานะ Wi-Fi
- กะพริบ: กำลังรอการเชื่อมต่อ / กำลังเชื่อมต่อ
  - เปิด: เชื่อมต่อแล้ว

#### หมายเหตุ:

- รองรับ Wi-Fi 2.4 GHz เท่านั้น
- หากต้องการรีเซ็ต Wi-Fi ให้ทำซ้ำขั้นตอนที่ (2) จากนั้นทำตามคำแนะนำเพื่อสิ้นสุดการเชื่อมต่อ Wi-Fi
- หากต้องการตัดการเชื่อมต่ออุปกรณ์จากเครือข่าย Wi-Fi ให้กดปุ่มรีเซ็ตบนหุ่นยนต์ค้างไว้ 3 วินาที
- เนื่องจากการอัปเดตในซอฟต์แวร์แอป การดำเนินการจริงอาจแตกต่างจากคำแนะนำในคู่มือนี้ โปรดทำตามคำแนะนำของแอปเวอร์ชันปัจจุบัน

### 4. ชาร์จหุ่นยนต์

เมื่อวางหุ่นยนต์ ให้จัดตำแหน่งหน้าสัมผัสการชาร์จของหุ่นยนต์ให้ตรงกับหน้าสัมผัสการชาร์จของแท่นชาร์จไฟ จากนั้นหุ่นยนต์จะเปิดและเริ่มการชาร์จโดยอัตโนมัติ

หลังจากชาร์จหุ่นยนต์เต็มแล้ว ไฟแสดงสถานะบนหุ่นยนต์และแท่นชาร์จไฟจะติดสว่างเป็นเวลา 10 นาที จากนั้นจะหรี่ลง

**หมายเหตุ:** ขอแนะนำให้ชาร์จหุ่นยนต์ให้เต็มก่อนที่จะเริ่มใช้งานเป็นครั้งแรก เมื่อแบตเตอรี่หมดและไม่สามารถใช้งานหุ่นยนต์ได้ โปรดเชื่อมต่อหุ่นยนต์กับแท่นชาร์จไฟด้วยตนเองเพื่อชาร์จแบตเตอรี่

### รูปที่ C-1-รูปที่ C-4

## D วิธีการใช้งาน

### เปิด/ปิด

กดปุ่มเปิดปิดค้างไว้ 3 วินาทีเพื่อเปิดหุ่นยนต์ ไฟแสดงสถานะการทำงานควรจะสว่างขึ้น วางหุ่นยนต์ลงบนแท่นชาร์จไฟ หุ่นยนต์ควรเปิดโดยอัตโนมัติและเริ่มการชาร์จ หากต้องการปิดหุ่นยนต์ ให้ย้ายหุ่นยนต์ออกจากแท่นชาร์จ และกดปุ่มเปิด/ปิดค้างไว้ 3 วินาที

### การสร้างแผนที่แบบรวดเร็ว

หลังจากกำหนดค่าเครือข่ายในครั้งแรก ให้ทำตามคำแนะนำในแอปเพื่อสร้างแผนที่อย่างรวดเร็ว หุ่นยนต์จะเริ่มทำแผนที่โดยไม่ทำความสะดวก เมื่อหุ่นยนต์กลับไปแท่นชาร์จไฟ กระบวนการที่แผนที่จะเสร็จสมบูรณ์และแผนที่จะถูกบันทึกโดยอัตโนมัติ

### เริ่มต้นการทำความสะดวก

กดปุ่มเปิด/ปิดเพื่อเริ่มการทำความสะดวกหลังจากเปิดหุ่นยนต์ หุ่นยนต์จะกำหนดเส้นทางอย่างแม่นยำ ทำความสะดวกตามขอบและผนังอย่างเป็นระบบ แล้วจึงเสร็จสิ้นการทำความสะดวกแต่ละห้องในรูปแบบรูปตัว S เพื่อให้แน่ใจว่าทำความสะดวกอย่างทั่วถึง

**หมายเหตุ:** แนะนำให้ปล่อยให้หุ่นยนต์ออกเดินทางจากแท่นชาร์จไฟก่อนทำความสะดวก อย่าเคลื่อนย้ายแท่นชาร์จไฟในขณะที่หุ่นยนต์กำลังทำความสะดวก สิ่งนี้ทำให้มั่นใจได้ว่าหุ่นยนต์จะกลับไปแท่นชาร์จไฟได้สำเร็จ

### หยุดชั่วคราว/พักเครื่อง

เมื่อหุ่นยนต์กำลังทำงาน ให้กดปุ่มใดก็ได้เพื่อหยุดชั่วคราว หากหุ่นยนต์หยุดชั่วคราวนานกว่า 10 นาที หุ่นยนต์จะเข้าสู่โหมดพักเครื่องโดยอัตโนมัติ ไฟแสดงสถานะทั้งหมดบนหุ่นยนต์จะปิดลง กดปุ่มใดก็ได้บนหุ่นยนต์หรือใช้แอปเพื่อเปิดใช้งานหุ่นยนต์

**หมายเหตุ:** หากหุ่นยนต์อยู่ในสถานะหยุดชั่วคราว และถูกวางลงบนแท่นชาร์จไฟ กระบวนการทำความสะอาดปัจจุบันจะสิ้นสุดลง

### ทำความสะอาดต่ออัตโนมัติ

หากแบตเตอรี่เหลือน้อยเกินไป หุ่นยนต์จะกลับไปแท่นชาร์จไฟโดยอัตโนมัติเพื่อทำการชาร์จ หลังจากชาร์จถึงระดับแบตเตอรี่ที่เหมาะสมแล้ว หุ่นยนต์จะกลับมาทำความสะอาดต่อ

**หมายเหตุ:** หากต้องการใช้ฟังก์ชันนี้ โปรดเปิดในแอป

### โหมดห้ามรบกวน (Do Not Disturb : DND)

เมื่อหุ่นยนต์ถูกตั้งค่าเป็นโหมดห้ามรบกวน (Do Not Disturb : DND) หุ่นยนต์จะถูกป้องกันไม่ให้กลับมาทำความสะอาดต่อ โหมด DND ถูกปิดใช้งานตามค่าเริ่มต้นจากโรงงาน คุณสามารถใช้แอปเพื่อเปิดใช้งานโหมด DND หรือแก้ไขช่วงเวลา DND ได้ ตามค่าเริ่มต้นช่วงเวลา DND คือ 22:00 - 8:00 น.

#### หมายเหตุ:

- แผนผังความสะอาดตามกำหนดเวลาจะดำเนินไปตามปกติในช่วงระยะเวลา DND
- หุ่นยนต์จะดำเนินการทำความสะอาดต่อจากที่ค้างไว้หลังจากช่วงเวลา DND สิ้นสุดลง

### การทำความสะอาดเฉพาะจุด

เมื่อหุ่นยนต์อยู่ในโหมดรอคำสั่ง ให้กดปุ่ม  ค้างไว้ 3 วินาที เพื่อเปิดใช้งานโหมดการทำความสะอาดเฉพาะจุด ในโหมดนี้ หุ่นยนต์จะทำความสะอาดพื้นที่รูปทรงสี่เหลี่ยมจัตุรัสขนาด 1.5 x 1.5 เมตร บริเวณโดยรอบของหุ่นยนต์และกลิ้งสู่จุดเริ่มต้น เมื่อการทำความสะอาดเฉพาะจุดเสร็จสิ้นแล้ว

### การรีเซ็ตาร์หุ่นยนต์

หากหุ่นยนต์หยุดตอบสนองหรือไม่สามารถเปิดได้ ให้กดปุ่มเปิด/ปิดค้างไว้ 10 วินาทีเพื่อบังคับให้หุ่นยนต์ปิดการทำงาน จากนั้นกดปุ่มเปิด/ปิดค้างไว้ 3 วินาทีเพื่อเปิดหุ่นยนต์

### ใช้ฟังก์ชันการถูพื้น

**หมายเหตุ:** ขอแนะนำให้ทำการดูดฝุ่นบนพื้นทั้งหมดอย่างน้อยสามครั้งก่อนทำการถูพื้นครั้งแรกเพื่อให้การทำความสะอาดได้ผลดีขึ้น

1. กดคลิกปลดเพื่อถอดถักเก็บน้ำ 2-in-1 พร้อมกล่องเก็บฝุ่น
2. เติมผาช่องเติมน้ำเข้า เติมน้ำลงในถังและปิดฝาให้สนิท

#### หมายเหตุ:

- ห้ามใช้ผงซักฟอกหรือน้ำยาฆ่าเชื้อ
  - ห้ามเติมน้ำร้อนลงในถังเก็บน้ำ เพราะอาจทำให้ถังเก็บน้ำบิดงอได้
3. ชุบผ้าถูพื้นให้หมาดและบิดน้ำส่วนเกินออก ดัดตั้งผ้าถูพื้นตามที่แสดงในรูปภาพ.
  4. ดัดตั้งถังเก็บน้ำ 2-in-1 พร้อมกล่องเก็บฝุ่นและชุดถูพื้น กลับเข้าที่ตามที่แสดงในรูปภาพ จนกระทั่งล็อกเข้าที่ กดปุ่มเปิด/ปิดหรือใช้แอปเพื่อเริ่มต้นการทำความสะอาด

#### หมายเหตุ:

- ไม่แนะนำให้ใช้ฟังก์ชันการถูพื้นบนพรม
  - ใช้แอปเพื่อปรับความชื้นของผ้าถูพื้นตามต้องการ
5. เมื่อหุ่นยนต์กลับมาชาร์จหลังจากทำความสะอาดแล้ว ถอดที่ขัดผ้าถูพื้นออก และทำความสะอาดผ้าถูพื้นเพื่อป้องกันเชื้อราหรือกลิ่นไม่พึงประสงค์

#### หมายเหตุ:

- ซักผ้าถูพื้นหลังการใช้งานทุกครั้ง และแทนที่ที่ไม่ได้ใช้ออกจากถังเก็บน้ำเป็นประจำ
- ถอดชุดถูพื้นออกเมื่อไม่ได้ถูพื้น

### รูปที่ D-1-รูปที่ D-5

## E การบำรุงรักษาตามรอบปกติ

### ชิ้นส่วน

เพื่อให้หุ่นยนต์อยู่ในสภาพดี ขอแนะนำให้อ้างอิงถึงการใช้อุปกรณ์เสริมในแอปหรือตารางต่อไปสำหรับการบำรุงรักษาตามปกติ

ชิ้นส่วน	ความถี่ในการบำรุงรักษา	ระยะเวลาการเปลี่ยน
ผ้าถูพื้น	หลังการใช้งานแต่ละครั้ง	ทุก 3 ถึง 6 เดือน
แปรงหลัก	ทุก 2 สัปดาห์	ทุก 6 ถึง 12 เดือน
แปรงด้านข้าง		ทุก 3 ถึง 6 เดือน
ตัวกรองของ กล่องเก็บฝุ่น		
พื้นที่รับส่งสัญญาณ ของแท่นชาร์จไฟ	เดือนละครั้ง	/
หน้าสัมผัสการชาร์จ		
เซ็นเซอร์เลเซอร์วัดระยะ (LDS)		
เซ็นเซอร์กลับแท่น		
กินเซน		
ด้านล่างของหุ่นยนต์		
ล้อแบบหมุนรอบ ทิศทาง		
เซ็นเซอร์ป้องกันการ ตกหล่น		

ชิ้นส่วน	ความถี่ในการบำรุงรักษา	ระยะเวลาการเปลี่ยน
กล่องเก็บฝุ่น	ทำความสะอาดเท่าที่จำเป็น	/
ล้อหลัก		
ถังเก็บน้ำ		

**หมายเหตุ:** ความถี่ในการเปลี่ยนจะขึ้นอยู่กับการใช้งานหุ่นยนต์ของคุณ หากมีข้อบกพร่องเกิดขึ้นเนื่องจากสถานการณ์พิเศษ ควรเปลี่ยนชิ้นส่วนนั้น

### แปรงหลัก

1. ถอดคลิปที่ครอบแปรงหลักเข้าด้านในเพื่อถอดที่ครอบแปรงหลักออกและยกแปรงออกจากหุ่นยนต์
2. แปรงปิดฝุ่นที่เหมาะสมเพื่อจัดเส้นผมที่พันกันอยู่ในแปรงจากนั้นติดตั้งแปรงและกดที่ครอบแปรงหลักเพื่อล็อกให้เข้าที่

#### รูป E-1

### แปรงด้านข้าง

ถอดและทำความสะอาดแปรงด้านข้าง

#### รูป E-2

### ลือแบบหมุนรอบทิศทาง

แปรงปิดฝุ่นที่เหมาะสมเพื่อจัดเส้นผมที่พันกันอยู่ในลือแบบหมุนรอบทิศทาง

#### รูป E-3

### ถังเก็บน้ำ 2-in-1 พร้อมกล่องเก็บฝุ่น

1. ถอดคลิปปลดเพื่อถอดถังเก็บน้ำ 2-in-1 พร้อมกล่องเก็บฝุ่นและเทน้ำในถังเก็บน้ำออกให้หมด
2. เปิดฝาปิดกล่องเก็บฝุ่นและเทฝุ่นออกจากกล่องเก็บฝุ่น
3. เปิดที่ยึดตัวกรองเพื่อถอดตัวกรอง HEPA ออกและแตะตัวกรอง HEPA เบาๆ

**หมายเหตุ:** อย่าพยายามทำความสะอาดตัวกรองด้วยแปรงนิ้วมือ หรือของมีคม เพื่อป้องกันการเกิดความเสียหาย

4. ล้างกล่องเก็บฝุ่นและตัวกรอง HEPA ด้วยน้ำสะอาดแล้วตากลมให้แห้งก่อนติดตั้งใหม่

### หมายเหตุ:

- ห้ามล้างชิ้นส่วนนอกกล่องเก็บฝุ่น หากมีคราบน้ำ โปรดเซ็ดให้แห้งก่อนติดตั้งใหม่
- ล้างกล่องเก็บฝุ่นและตัวกรองด้วยน้ำสะอาดเท่านั้น ห้ามใช้ผงซักฟอกทุกประเภท
- ใช้กล่องเก็บฝุ่นและตัวกรองที่ต่อเมื่ออุปกรณ์เหล่านี้แห้งสนิทแล้วเท่านั้น

#### รูป E-4

### ผ้าถูพื้น

1. ถอดชุดถูพื้นออกและดึงผ้าถูพื้นออกจากที่ยึดผ้าถูพื้น
2. ถอดผ้าถูพื้นออกแล้วทำความสะอาดด้วยน้ำเปล่าเท่านั้น จากนั้นเช็ดให้แห้งสนิทก่อนติดตั้งกลับเข้าไปใหม่

#### รูป E-5

### เซ็นเซอร์หุ่นยนต์

เช็ดเซ็นเซอร์ของหุ่นยนต์โดยใช้ผ้าขนหนูแห้ง ดังภาพตัวอย่าง:

1. เซ็นเซอร์เลเซอร์วัดระยะ (LDS)
2. กันชน
3. เซ็นเซอร์กลับแท่น
4. เซ็นเซอร์ป้องกันการตกหล่น

**หมายเหตุ:** ผ้าเปียกสามารถสร้างความเสียหายให้แก่ส่วนประกอบที่ละเอียดอ่อนภายในหุ่นยนต์และแท่นชาร์จไฟได้ โปรดใช้ผ้าขนหนูแห้งในการทำความสะอาด

#### รูป E-6

### หน้าสัมผัสการชาร์จและ พื้นที่รับส่งสัญญาณ

ทำความสะอาดหน้าสัมผัสการชาร์จและพื้นที่รับส่งสัญญาณด้วยผ้าขนหนูแห้ง

#### รูป E-7

### แบตเตอรี่

หุ่นยนต์มีชุดแบตเตอรี่ลิเทียมไอออนประสิทธิภาพสูงบรรจุอยู่ในภายใน ตรวจสอบให้แน่ใจว่าแบตเตอรี่ยังคงชาร์จไว้อย่างดีสำหรับการใช้งานทุกวันเพื่อรักษาประสิทธิภาพแบตเตอรี่ที่ดีที่สุด หากไม่ได้ใช้งานหุ่นยนต์เป็นระยะเวลานาน ให้ปิดและนำไปเก็บ เพื่อป้องกันความเสียหายจากการคายประจุจนเกินไป ควรชาร์จหุ่นยนต์อย่างน้อยทุกๆ สามเดือน

## การแก้ไขปัญหา

ปัญหา	วิธีการแก้ไข
ไม่สามารถเปิดใช้งานหุ่นยนต์ได้	<ul style="list-style-type: none"> <li>• แบตเตอรี่ต่ำ ชาร์จหุ่นยนต์บนแท่นชาร์จไฟ และลองอีกครั้ง</li> <li>• อุณหภูมิของแบตเตอรี่ต่ำหรือสูงเกินไป ขอบแนะนำให้งานหุ่นยนต์ที่อุณหภูมิระหว่าง 32°F (0°C) ถึง 104°F (40°C)</li> </ul>
ไม่สามารถชาร์จหุ่นยนต์ได้	<ul style="list-style-type: none"> <li>• แท่นชาร์จไฟไม่ได้เชื่อมต่อกับแหล่งจ่ายไฟ โปรดตรวจสอบให้แน่ใจว่าได้เสียบปลั๊กอะแดปเตอร์ทั้งสองด้านอย่างถูกต้องแล้ว</li> <li>• จุดเชื่อมต่อระหว่างจุดเชื่อมต่อการชาร์จบนแท่นชาร์จไฟและหุ่นยนต์ไม่ดี โปรดทำความสะอาดหน้าสัมผัสการชาร์จ</li> </ul>
หุ่นยนต์เชื่อมต่อกับ Wi-Fi ล้มเหลว	<ul style="list-style-type: none"> <li>• รหัสผ่านเครือข่าย Wi-Fi ไม่ถูกต้อง ตรวจสอบให้แน่ใจว่ารหัสผ่านที่ใช้เชื่อมต่อกับเครือข่าย Wi-Fi ของคุณถูกต้อง</li> <li>• หุ่นยนต์ไม่รองรับการเชื่อมต่อ Wi-Fi 5 GHz ตรวจสอบให้แน่ใจว่าหุ่นยนต์เชื่อมต่อการเชื่อมต่อ Wi-Fi 2.4 GHz</li> <li>• สัญญาณ Wi-Fi ไม่เสถียร ตรวจสอบให้แน่ใจว่าหุ่นยนต์อยู่ในพื้นที่ที่มีสัญญาณ Wi-Fi เสถียรและราบรื่น</li> <li>• หุ่นยนต์อาจไม่พร้อมสำหรับการตั้งค่า โปรดออกและเข้าแอปใหม่ จากนั้น ลองอีกครั้งตามคำแนะนำ</li> </ul>

ปัญหา	วิธีการแก้ไข
หุ่นยนต์ไม่สามารถกลับสู่แท่นชาร์จไฟได้	<ul style="list-style-type: none"> <li>• เส้นทางสำหรับการกลับสู่การชาร์จถูกปิดกั้น เช่น ประตูถูกปิดอยู่</li> <li>• แท่นชาร์จไฟถูกตัดการเชื่อมต่อจากไฟฟ้าหรือถูกเคลื่อนย้ายเมื่อหุ่นยนต์ไม่ได้อยู่บนแท่นแล้ว โปรดเชื่อมต่อแท่นชาร์จไฟกับแหล่งจ่ายไฟหรือวางหุ่นยนต์บนแท่นชาร์จไฟเพื่อทำการชาร์จ</li> <li>• มีสิ่งกีดขวางรอบๆ แท่นชาร์จไฟมากเกินไป วางแท่นชาร์จไฟในพื้นที่โล่ง</li> <li>• การเคลื่อนย้ายหุ่นยนต์อาจทำให้หุ่นยนต์เปลี่ยนตำแหน่งตัวเองและจะสร้างแผนที่ใหม่หากการวางตำแหน่งใหม่ล้มเหลว หากหุ่นยนต์อยู่ห่างจากแท่นชาร์จไฟมากเกินไป หุ่นยนต์อาจไม่สามารถกลับมาได้เองโดยอัตโนมัติ ซึ่งในกรณีนี้ คุณจะต้องวางหุ่นยนต์ลงบนแท่นชาร์จไฟด้วยตนเอง</li> <li>• เช็ดพื้นที่รับส่งสัญญาณบนแท่นชาร์จไฟเพื่อขจัดฝุ่นหรือสิ่งสกปรก</li> </ul>
หุ่นยนต์ติดอยู่หน้าแท่นชาร์จไฟและไม่สามารถกลับเข้าแท่นได้	<ul style="list-style-type: none"> <li>• ตรวจสอบว่ามีพื้นที่เพียงพอทั้งด้านข้างและด้านหน้าของแท่นชาร์จไฟเพื่อป้องกันไม่ให้หุ่นยนต์ถูกลบวาง</li> <li>• หุ่นยนต์อาจสั่นไหวได้หากพื้นด้านหน้าแท่นชาร์จไฟเปียกมากเกินไป หากเป็นเช่นนั้น ให้เช็ดคราบน้ำออกก่อนแล้วลองอีกครั้ง</li> <li>• ขอบแนะนำให้อ้ายแท่นชาร์จไฟไปที่อื่นแล้วลองอีกครั้ง</li> </ul>

## การแก้ไขปัญหา

ปัญหา	วิธีการแก้ไข
หุ่นยนต์ไม่ยอมปิดเครื่อง	<ul style="list-style-type: none"> <li>ไม่สามารถปิดหุ่นยนต์ได้ในขณะที่กำลังชาร์จ ขอแนะนำให้ย้ายหุ่นยนต์ออกแท่นชาร์จไฟ จากนั้นกดปุ่มเปิด / ปิดค้างไว้เป็นเวลา 3 วินาทีเพื่อเปิดเครื่อง</li> <li>หากไม่สามารถปิดหุ่นยนต์ตามขั้นตอนที่ 1 ได้ ให้กดปุ่มเปิดปิดค้างไว้ 10 วินาทีเพื่อบังคับปิดหุ่นยนต์ หากยังคงพบปัญหาโปรดติดต่อฝ่ายบริการหลังการขาย</li> </ul>
ชาร์จช้า	<ul style="list-style-type: none"> <li>เมื่อแบตเตอรี่เหลือน้อยจะใช้เวลาประมาณ 4.5 ชั่วโมงในการชาร์จหุ่นยนต์จนเต็ม</li> <li>หากคุณใช้งานหุ่นยนต์ที่อุณหภูมิออกเหนือจากช่วงที่กำหนด ความเร็วในการชาร์จจะช้าลงโดยอัตโนมัติเพื่อยืดอายุการใช้งานแบตเตอรี่</li> <li>หมั่นล้างผู้สกรูชาร์จของทั้งหุ่นยนต์และแท่นชาร์จไฟออกสกรก โปรตเช็คด้วยผ้าขนหนูแห้ง</li> </ul>
เกิดเสียงดังในขณะที่หุ่นยนต์กำลังทำงาน	<ul style="list-style-type: none"> <li>ตรวจสอบว่าตัวกรองของกล่องเก็บฝุ่นอุดตันหรือไม่ หากใช่ โปรดทำความสะอาดหรือเปลี่ยนใหม่</li> <li>วัตถุที่เป็นของแข็งอาจติดอยู่ในแปรงหลักหรือกล่องเก็บฝุ่น ตรวจสอบและนำวัตถุแข็งออก</li> <li>แปรงหลักหรือแปรงด้านข้างอาจพันกันได้ ตรวจสอบและนำวัตถุแปลกปลอมออก</li> <li>เปลี่ยนหมัดการดูดเป็นมาตรฐานหรือเงียบ</li> </ul>
หุ่นยนต์ไม่เคลื่อนที่ตามเส้นทางที่กำหนดไว้	<ul style="list-style-type: none"> <li>ควรเก็บวัตถุต่างๆ เช่น สายไฟและรองเท้าก่อนใช้งานหุ่นยนต์</li> <li>การทำงานบนพื้นผิวที่เปียกชื้นอาจทำให้ล้อหลักสั่นไถล แนะนำให้เช็ดบริเวณที่เปียกให้แห้งก่อนใช้งานหุ่นยนต์</li> </ul>

ปัญหา	วิธีการแก้ไข
หุ่นยนต์ไม่ทำความสะอาดห้องที่กำหนดไว้	<ul style="list-style-type: none"> <li>ตรวจสอบให้แน่ใจว่าประตูห้องที่จะทำความสะอาดเปิดอยู่</li> <li>ตรวจสอบว่ามีธรณีประตูสูงกว่า 2 ซม. ที่ประตูห้องหรือไม่ หุ่นยนต์ไม่สามารถข้ามธรณีประตูหรือขั้นบันไดที่สูงกว่าที่กำหนดได้</li> <li>บริเวณหน้าห้องที่จะทำความสะอาดอาจเปียกและลื่น ทำให้หุ่นยนต์สั่นไถลและทำงานผิดพลาดได้ โปรดเช็ดพื้นให้แห้งก่อนใช้งานหุ่นยนต์</li> </ul>
หุ่นยนต์ไม่ทำความสะอาดต่อหลังชาร์จแบตเตอรี่	<ul style="list-style-type: none"> <li>ตรวจสอบให้แน่ใจว่าไม่ได้ตั้งค่าหุ่นยนต์เป็นโหมดห้ามรบกวน (Do Not Disturb : DND) ซึ่งจะทำให้ไม่สามารถทำความสะอาดต่อได้</li> <li>หุ่นยนต์จะไม่กลับมาทำความสะอาดหลังจากที่คุณวางหุ่นยนต์ด้วยตนเองบนแท่นหรือส่งหุ่นยนต์ไปชาร์จผ่านแอปหรือปุ่ม </li> </ul>
ไม่มีน้ำไหลออกจากถังเก็บน้ำหรือออกมาเพียงเล็กน้อย	<ul style="list-style-type: none"> <li>ตรวจสอบว่ามีน้ำอยู่ภายในถังเก็บน้ำหรือไม่</li> <li>ทำความสะอาดผ้าอุ้งพื้นหากสกปรก</li> <li>ตรวจสอบให้แน่ใจว่าผ้าอุ้งพื้นและที่ยึดผ้าอุ้งพื้นได้รับการติดตั้งอย่างถูกต้องตามคู่มือการใช้งาน</li> </ul>
หุ่นยนต์ทำงานผิดพลาด	<ul style="list-style-type: none"> <li>ปิดหุ่นยนต์แล้วเปิดใช้งานใหม่อีกครั้ง</li> </ul>

## การแก้ไขปัญหา

ปัญหา	วิธีการแก้ไข
หุ่นยนต์ไม่มีประสิทธิภาพในการทำความสะอาดหรือกึ่งฝุ่นเอาไว้	<ul style="list-style-type: none"> <li>• ถล่องเก็บฝุ่นเต็ม โปรดทำความสะอาด</li> <li>• ตัวกรองถูกปิดกั้น โปรดทำความสะอาด</li> <li>• มีสิ่งแปลกปลอมติดอยู่ในแปรงหลัก โปรดทำความสะอาด</li> </ul>
หุ่นยนต์ไม่ทำความสะอาดตามกำหนดเวลา	<ul style="list-style-type: none"> <li>• หุ่นยนต์มีแบตเตอรี่ต่ำ การทำความสะอาดตามกำหนดเวลาจะไม่เริ่มทำงานเว้นแต่หุ่นยนต์จะมีแบตเตอรี่เหลืออย่างน้อย 15%</li> </ul>

สำหรับการสนับสนุนเพิ่มเติม โปรดติดต่อเราทาง <https://global.dreameotech.com>

## ข้อมูลจำเพาะ

### หุ่นยนต์

รุ่น	RLF41GA
เวลาในการชาร์จ	ประมาณ 4.5 ชั่วโมง
แรงดันไฟฟ้า	14.4 V ---
กำลังไฟ	45 W
ความถี่ในการทำงาน	2400-2483.5 MHz
กำลังเอาต์พุตสูงสุด	< 20 dBm

ภายใต้สภาพการใช้งานปกติ อุปกรณ์นี้ควรอยู่ห่างจากเสาอากาศและร่างกายของผู้ใช้งานอย่างน้อย 20 ซม.

### ชุดแบตเตอรี่ลิเทียมไอออนแบบชาร์จไฟได้

รุ่น	C1251A6
ประเภท	ลิเทียมไอออน
ตัวเลข	1
อัตราความจุ	2.95 Ah

### แท่นชาร์จไฟ

รุ่น	RCFA0301
อัตราอินพุต	20 V --- 1 A
อัตราเอาต์พุต	20 V --- 1 A

### อะแดปเตอร์

ผู้ผลิต	Shenzhen CHANZEHO Technology Co., Limited
รุ่น	CZH024N200100EUWA1
อัตราอินพุต	100-240 V~ 50/60 Hz สูงสุด 0.8 A
อัตราเอาต์พุต	20 V --- 1 A 20 W
ประสิทธิภาพการทำงานโดยเฉลี่ย	85.47%
ประสิทธิภาพที่โหลดต่ำ (10%)	81.30%
การใช้พลังงานขณะไม่มีโหลด	< 0.1 W

## การทิ้งและการถอดแบตเตอรี่

ภายในแบตเตอรี่ลิเทียมไอออนมีสารที่เป็นอันตรายต่อสิ่งแวดล้อม ก่อนทิ้งแบตเตอรี่ ตรวจสอบให้แน่ใจว่าช่างผู้ชำนาญการได้ถอดแบตเตอรี่ออกแล้วนำไปทิ้งที่โรงงานรีไซเคิลที่เหมาะสม

- ต้องถอดแบตเตอรี่ออกจากเครื่องก่อนที่จะทิ้ง
- ต้องถอดอุปกรณ์ออกจากแหล่งจ่ายไฟหลักเมื่อถอดแบตเตอรี่ออก
- ควรทิ้งแบตเตอรี่อย่างปลอดภัย

### ข้อควรระวัง:

ก่อนถอดแบตเตอรี่ ให้ถอดสายไฟออกและปล่อยให้แบตเตอรี่หมดไฟมากที่สุด

ควรทิ้งแบตเตอรี่ที่ไม่ต้องการที่โรงงานรีไซเคิลที่เหมาะสมอย่าให้อยู่ในสภาพแวดล้อมที่มีอุณหภูมิสูงเพื่อหลีกเลี่ยงความเสี่ยงจากการระเบิด

ภายใต้สภาวะที่ไม่เหมาะสม ของเหลวอาจรั่วไหลออกมาจากแบตเตอรี่ หากมีการสัมผัสเกิดขึ้น ให้ล้างออกด้วยน้ำสะอาดและขอความช่วยเหลือจากแพทย์

### คู่มือการถอด:

1. พลิกหุ่นยนต์ ใช้เครื่องมือที่เหมาะสมเพื่อถอดสกรูที่ด้านหลังของหุ่นยนต์ จากนั้น ถอดฝาปิดออก
2. ถอดขั้วระหว่างแบตเตอรี่และบอร์ด PCB เพื่อถอดแบตเตอรี่ออก

## ข้อมูล WEEE



ผลิตภัณฑ์ทั้งหมดที่มีสัญลักษณ์นี้เป็นขยะอิเล็กทรอนิกส์ (WEEE ตามข้อบังคับที่ 2012/19/EU) ซึ่งไม่ควรปะปนกับขยะในครัวเรือนที่ไม่ได้แยกประเภท คุณควรปกป้องสุขภาพของมนุษย์และสิ่งแวดล้อมด้วยการนำอุปกรณ์ของคุณไปยังจุดรวบรวมขยะอิเล็กทรอนิกส์ที่กำหนด ซึ่งตั้งโดยรัฐบาลหรือหน่วยงานท้องถิ่น การกำจัดและการรีไซเคิลที่ถูกต้องจะช่วยป้องกันผลเสียที่อาจเกิดขึ้นกับสิ่งแวดล้อมและสุขภาพของมนุษย์ โปรดติดต่อผู้ติดตั้งหรือเจ้าหน้าที่ท้องถิ่นเพื่อขอข้อมูลเพิ่มเติมเกี่ยวกับสถานที่ ตลอดจนข้อกำหนดและเงื่อนไขของจุดรวบรวมดังกล่าว

## Informasi Keamanan

Untuk menghindari sengatan listrik, kebakaran, atau cedera yang disebabkan oleh penggunaan alat yang tidak sesuai, baca panduan pengguna dengan cermat sebelum menggunakan alat dan gunakan sebagai referensi untuk masa mendatang.

## Batasan Penggunaan

- Sebaiknya produk ini tidak digunakan oleh anak-anak di bawah umur 8 tahun atau orang yang mengidap kelainan fisik, indra, intelektual, atau kurangnya pengalaman atau pengetahuan tanpa pengawasan dari orang tua atau wali untuk memastikan pengoperasian yang aman dan menghindari risiko apa pun. Pembersihan atau perawatan tidak boleh dilakukan oleh anak-anak tanpa pengawasan.
- Anak-anak tidak boleh bermain dengan produk ini. Pastikan anak-anak dan hewan peliharaan berada dalam jarak yang aman saat robot beroperasi.
- Produk ini digunakan khusus untuk membersihkan lantai di lingkungan rumah. Jangan digunakan di luar ruangan, atau di permukaan yang bukan lantai, atau di lingkungan industri atau komersial.
- Jika adaptor rusak, segera hentikan penggunaan dan hubungi layanan purnajual.
- Jangan gunakan robot di area yang digantung di atas permukaan tanah tanpa penghalang sebagai pengaman.
- Jangan letakkan robot secara terbalik. Jangan gunakan penutup LDS, penutup robot, atau bumper sebagai pegangan robot.
- Gunakan robot di lingkungan dengan suhu sekitar di atas 0 °C dan di bawah 40 °C. Pastikan tidak ada benda lengket atau cair di lantai.

## Informasi Keamanan

- Singkirkan kabel apa pun dari lantai sebelum menggunakan robot agar kabel tidak terseret saat robot melakukan pembersihan.
- Pindahkan barang yang mudah pecah dan barang kecil dari lantai agar robot tidak menabraknya dan mengakibatkan kerusakan.
- Untuk mencegah kerusakan atau bahaya yang disebabkan dari alat yang menyeret, bersihkan benda yang kendur dari lantai, dan lepaskan kabel atau kabel daya di jalur pembersihan sebelum mengoperasikan alat.
- Jauhkan rambut, jari, dan bagian tubuh lainnya dari lubang penyedot pada robot.
- Jauhkan alat pembersih sikat dari jangkauan anak-anak.
- Jangan letakkan anak-anak, hewan peliharaan, atau barang apa pun di atas robot, baik saat robot sedang diam maupun bergerak.
- Jangan gunakan robot untuk membersihkan benda yang terbakar. Jangan gunakan robot untuk mengambil cairan yang mudah terbakar, gas korosif, atau asam pelarut murni.
- Jangan menyedot objek yang keras atau tajam. Jangan menggunakan alat untuk mengambil objek seperti batu, lembaran kertas yang besar, atau barang apa pun yang dapat menyumbat alat.
- Pastikan robot dimatikan dan dok pengisian daya tidak tersambung ke listrik sebelum membersihkan atau melakukan perawatan.
- Jangan gunakan kain basah untuk mengelap atau cairan apa pun untuk membilas robot dan dok pengisian daya. Bagian yang dapat dicuci harus benar-benar dikeringkan sebelum dipasang dan digunakan.

## Informasi Keamanan

- Pastikan robot dimatikan saat diangkat dan dimasukkan di kemasan aslinya jika memungkinkan.
- Gunakan produk ini sesuai dengan petunjuk di Panduan Pengguna. Pengguna bertanggung jawab atas kerusakan atau kerugian yang timbul dari penggunaan produk ini yang tidak sesuai.

## Baterai dan Pengisian Daya

- **PERINGATAN:** Jangan mengisi ulang baterai yang tidak dapat diisi ulang
- Jangan gunakan baterai, adaptor, atau dok pengisian daya pihak ketiga. Hanya gunakan alat ini dengan unit catu daya RCFA0301.
- Jangan coba membongkar, memperbaiki, atau memodifikasi baterai atau dok pengisian daya sendiri.
- Jangan letakkan dok pengisian daya di dekat sumber panas.
- Jangan gunakan kain basah atau tangan basah untuk mengelap atau membersihkan kontak dok pengisian daya.
- Jangan buang baterai lama dengan cara yang tidak sesuai aturan. Baterai yang tidak diperlukan harus dibuang di fasilitas daur ulang yang sesuai.
- Jika robot tidak akan digunakan dalam waktu lama, isi dayanya hingga penuh, lalu matikan dan simpan di tempat yang sejuk dan kering. Isi ulang daya robot setidaknya sekali setiap 3 bulan untuk menghindari pelepasan daya baterai yang berlebihan.
- Produk ini menggunakan baterai yang hanya boleh diganti oleh teknisi berkualifikasi atau layanan purnajual.

## Informasi Keamanan

### Informasi Keamanan Laser

- Sensor laser dalam produk ini memenuhi Standar IEC 60825-1:2014/EN 60825-1:2014/A11:2021 untuk produk laser Kelas 1. Hindari kontak mata langsung dengan laser ini selama penggunaan.

PRODUK LASER KELAS 1

PRODUK LASER KONSUMEN

EN 50689:2021



Hanya untuk penggunaan dalam ruangan



Baca panduan operator

Dengan ini, Dreame Trading (Tianjin) Co., Ltd. menyatakan bahwa perlengkapan radio jenis RLF41GA memenuhi Pedoman 2014/53/EU. Teks lengkap deklarasi kesesuaian Uni Eropa tersedia di alamat internet berikut: <https://global.dreametech.com>

Untuk perincian panduan elektroniknya, buka <https://global.dreametech.com/pages/user-manuals-and-faqs>

## A Ikhtisar Produk

### Robot

1. Tombol Daya/Bersihkan
    - Tekan dan tahan selama 3 detik untuk menyalakan atau mematikan
    - Tekan untuk memulai pembersihan setelah robot dinyalakan
  2. Tombol Pembersihan Spot/Dok 
    - Tekan untuk mengirim robot kembali ke dok pengisian daya
    - Tekan dan tahan selama 3 detik untuk memulai pembersihan spot
- Indikator Status Tombol
- Putih Menyala: Pembersihan selesai
  - Oranye Berkedip: Kesalahan
  - Putih Bernapas: Robot sedang diisi daya saat daya baterai tidak lemah

### Catatan:

- Tekan tombol mana saja pada robot untuk menjeda saat robot sedang melakukan pembersihan atau mengembalikan ke pengisian daya.
  - Tekan dan tahan tombol daya dan tombol dok selama 3 detik untuk mengatur ulang Wi-Fi.
  - Kunci Anak dapat diaktifkan/dinonaktifkan melalui aplikasi Dreamehome.
3. Penutup LDS
  4. Laser Sensor Jarak (LDS)
  5. Bumper
  6. Sikat Samping
  7. Roda Utama
  8. Sensor Antijatu
  9. Roda Segala Arah
  10. Klip Pelindung Sikat

11. Roda Utama
12. Sikat Utama
13. Pelindung Sikat
14. Tombol Atur Ulang
  - Tekan dan tahan selama 3 detik untuk memulihkan ke pengaturan pabrik
15. Kontak Pengisian Daya
16. Tangki Air 2-in-1 dengan Kotak Debu
17. Sensor Kembali ke Dok
18. Rakitan Pel

### Gbr. A-1

### Tangki Air 2-in-1 dengan Kotak Debu

1. Dudukan Filter
2. Filter HEPA
3. Penutup Saluran Pengisian Air
4. Saluran Pengisian Air
5. Klip Pelepas

### Gbr. A-2

### Rakitan Pel

1. Penjepit Kain Pel
2. Klip Pelepas
3. Area Pemasangan Kain Pel
4. Kain Pel

### Gbr. A-3

### Dok Pengisian Daya

1. Kontak Pengisian Daya
2. Area Pemancar Sinyal
3. Stopkontak

### Gbr. A-4

## B Menyiapkan Rumah Anda

ID

1. Sebelum pembersihan, singkirkan barang yang mudah jatuh, rapuh, berharga, atau berbahaya, dan rapikan kabel, pakaian, mainan, benda keras, dan benda tajam di permukaan lantai agar tidak tersangkut, tergores, atau terjatuh karena robot sehingga menyebabkan kerugian.
2. Sebelum membersihkan, letakkan penghalang fisik di sudut tangga untuk memastikan robot beroperasi dengan lancar dan aman.
3. Buka pintu ruangan yang akan dibersihkan, dan letakkan perabot sesuai tempatnya untuk memberikan ruang yang lebih luas.
4. Agar robot mengenali area yang perlu dibersihkan, jangan berdiri di depan robot, atau di depan pintu, lorong, atau ruangan sempit.

### Catatan:

- Saat mengoperasikan robot untuk pertama kali, ikuti robot saat membersihkan untuk menyingkirkan rintangan tepat waktu.
- Jangan menyedot benda yang keras seperti batu, bola baja, dan komponen mainan, ataupun benda tajam seperti sampah konstruksi, pecahan kaca, dan kuku karena dapat menyebabkan permukaan lantai tergores.

### Gbr. B

## C Sebelum Digunakan

### 1. Letakkan Dok Pengisian Daya dan Sambungkan ke Stopkontak

kelupas selotip dua sisi di bagian bawah dok pengisian daya. Letakkan dok pengisian daya di lokasi terbuka dengan sinyal Wi-Fi yang bagus. Sisakan ruang yang cukup seperti yang ditunjukkan pada gambar dan singkirkan objek apa pun di area yang diarsir. Masukkan adaptor ke dok pengisian daya dan sambungkan ke soket.

#### Catatan:

- Singkirkan benda apa pun yang berjarak kurang dari 1,5 m dari depan dan 0,5 m dari kedua sisi dok pengisian daya.
- Jangan letakkan dok pengisian daya di area yang terkena sinar matahari langsung atau di tempat dengan benda lain yang dapat menghalangi sinyal. Hal ini dapat membuat robot tidak bisa kembali ke dok pengisian daya.
- Untuk mencegah noda air mengotori lantai kayu atau karpet, disarankan untuk meletakkan dok pengisian daya di lantai keramik atau marmer.

### 2. Lepas Pelindung dan Pasang Sikat Samping

### 3. Hubungkan dengan Aplikasi Dreamehome

- (1) Tekan dan tahan tombol daya pada robot selama 3 detik untuk menyalakan robot. Pindai kode QR pada robot atau telusuri "Dreamehome" di toko aplikasi untuk mengunduh dan menginstal aplikasi.
- (2) Buka aplikasi Dreamehome, ketuk "Pindai kode QR untuk menghubungkan", dan pindai lagi kode QR yang sama pada robot untuk menambahkan perangkat. Harap ikuti arahan

untuk menyelesaikan penyambungan Wi-Fi.

- ① Kode QR
  - ② Indikator Wi-Fi
- Berkedip: Akan Dihubungkan / Sedang Menghubungkan
  - Aktif: Terhubung

#### Catatan:

- Hanya mendukung Wi-Fi 2,4 GHz.
- Untuk mengatur ulang Wi-Fi, ulangi langkah (2), kemudian ikuti arahan untuk menyelesaikan penyambungan Wi-Fi.
- Untuk memutus koneksi perangkat dari jaringan Wi-Fi, tekan dan tahan tombol Atur Ulang pada robot selama 3 detik.
- Adanya peningkatan pada perangkat lunak aplikasi, pengoperasian sebenarnya mungkin berbeda dengan arahan dalam manual ini. Harap ikuti petunjuk berdasarkan versi aplikasi saat ini.

### 4. Isi Daya Robot

Saat meletakkan robot, selaraskan kontak pengisian daya robot dengan kontak pengisian daya pada dok pengisian daya. Dengan demikian, robot akan otomatis menyala dan mulai mengisi daya.

Setelah daya robot terisi penuh, indikator status pada robot dan dok pengisian daya akan tetap menyala selama 10 menit lalu meredup.

**Catatan:** Sebaiknya isi penuh daya robot sebelum digunakan untuk pertama kali. Saat robot tidak dapat dinyalakan setelah baterai habis, sambungkan robot ke dok pengisian daya secara manual untuk mengisi daya.

#### Gbr. C-1-Gbr. C-4

## D Cara Menggunakan

### Menyalakan/Mematikan

Tekan dan tahan tombol daya selama 3 detik untuk menyalakan robot. Indikator daya akan menyala. Letakkan robot di dok pengisian daya. Robot akan menyala secara otomatis dan mulai mengisi daya. Untuk mematikan robot, jauhkan robot dari dok pengisian daya, lalu tekan dan tahan tombol daya selama 3 detik.

### Pemetaan Cepat

Setelah mengonfigurasi jaringan untuk pertama kali, ikuti instruksi di aplikasi untuk membuat peta dengan cepat. Robot akan mulai memetakan tanpa membersihkan. Saat robot kembali ke dok pengisian daya, proses pemetaan telah selesai dan peta akan disimpan secara otomatis.

### Mulai Pembersihan

Tekan tombol daya untuk memulai pembersihan setelah robot dinyalakan. Robot akan memetakan rute secara akurat, membersihkan tepian dan dinding secara sistematis, lalu mengakhiri dengan membersihkan setiap ruangan dalam pola gerakan S untuk memastikan hasil kerja yang menyeluruh.

**Catatan:** Sebaiknya robot disiapkan dari dok pengisian daya sebelum membersihkan. Jangan pindahkan dok pengisian daya saat robot sedang membersihkan. Hal ini untuk memastikan robot dapat kembali ke dok pengisian daya tanpa masalah.

## Jeda/Tidur

Saat robot bekerja, tekan tombol apa pun untuk menjeda.

Jika robot dijeda selama lebih dari 10 menit, robot akan otomatis memasuki mode tidur. Semua indikator pada robot akan mati. Tekan tombol apa pun pada robot, atau gunakan aplikasi untuk membangunkan robot.

**Catatan:** Jika robot dijeda dan diletakkan pada dok pengisian daya, proses pembersihan yang sedang berjalan akan berakhir.

## Melanjutkan Pembersihan Otomatis

Jika baterai terlalu lemah, robot akan secara otomatis kembali ke dok pengisian daya untuk mengisi daya. Pembersihan yang belum selesai akan dilanjutkan setelah mengisi daya hingga level baterai yang sesuai.

**Catatan:** Untuk menggunakan fungsi ini, aktifkan di aplikasi.

## Mode Jangan Ganggu (DND)

Saat robot diatur ke mode Jangan Ganggu (DND), robot tidak akan melanjutkan pembersihan. Mode DND dinonaktifkan secara default pada pengaturan pabrik. Anda dapat menggunakan aplikasi untuk mengaktifkan mode DND atau memodifikasi periode DND. Periode DND adalah pukul 22:00–8:00 secara default.

**Catatan:**

- Pembersihan terjadwal akan dijalankan seperti biasa selama periode DND.

- Robot akan melanjutkan pembersihan yang belum selesai setelah periode DND berakhir.

## Pembersihan Spot

Saat robot dalam mode menunggu, tekan dan tahan tombol  selama 3 detik untuk mengaktifkan mode pembersihan spot. Dalam mode ini, robot membersihkan area berbentuk persegi seluas 1,5 × 1,5 meter di sekitarnya dan kembali ke titik awal setelah pembersihan spot selesai.

## Memulai Ulang Robot

Jika robot berhenti merespons atau tidak dapat dimatikan, tekan dan tahan tombol daya selama 10 detik untuk memaatkannya secara paksa. Kemudian, tekan dan tahan tombol daya selama 3 detik untuk menyalakan robot.

## Menggunakan Fungsi Pengepelan

**Catatan:** Sebaiknya semua lantai divakum setidaknya tiga kali sebelum sesi mengepel pertama untuk mendapatkan efek pembersihan yang lebih baik.

1. Tekan klip pelepas untuk melepas tangki air 2-in-1 dengan kotak debu.
2. Buka penutup saluran pengisian air, isi tangki dengan air, lalu tutup dengan rapat.

**Catatan:**

- Jangan gunakan detergen atau disinfektan.
- Jangan isi tangki air dengan air panas karena dapat menyebabkan tangki air berubah bentuk.

3. Basahi kain pel, lalu peras hingga kering. Pasang kain pel seperti di gambar.
4. Pasang kembali tangki air 2-in-1 dengan kotak debu dan rakitan pel seperti yang ditunjukkan di gambar hingga terdengar bunyi klik. Tekan tombol daya atau gunakan aplikasi untuk memulai pembersihan.

**Catatan:**

- Fungsi pengepelan tidak disarankan untuk digunakan pada karpet.
- Gunakan aplikasi untuk mengatur kelembapan kain pel sesuai kebutuhan.
- 5. Saat robot kembali untuk mengisi daya setelah pembersihan, lepaskan penjepit kain pel, lalu bersihkan kain pel untuk mencegah munculnya jamur atau bau.

**Catatan:**

- Cuci kain pel setelah digunakan dan buang air yang tidak terpakai di tangki air secara rutin.
- Lepaskan rakitan pel saat tidak mengepel.

**Gbr. D-1-Gbr. D-5**

## E Perawatan Rutin

### Bagian-Bagian

Agar robot tetap dalam kondisi baik, sebaiknya lihat panduan penggunaan aksesoris di aplikasi atau tabel berikut untuk perawatan rutin.

Bagian	Frekuensi Perawatan	Periode Penggantian
Kain pel	Setelah setiap kali penggunaan	Setiap 3 sampai 6 bulan
Sikat utama	Setiap 2 minggu sekali	Setiap 6 sampai 12 bulan
Sikat samping		Setiap 3 sampai 6 bulan
Filter kotak debu		
Area pemancar sinyal dok pengisian daya	Sekali setiap bulan	/
Kontak pengisian daya		
Laser sensor jarak (LDS)		
Sensor kembali ke dok		
Bumper		
Bagian bawah robot		
Roda segala arah		
Sensor antijatuhan		

Bagian	Frekuensi Perawatan	Periode Penggantian
Kotak debu	Bersihkan sesuai kebutuhan	/
Roda utama		
Tangki air		

**Catatan:** Frekuensi penggantian bergantung pada penggunaan robot Anda. Jika kerusakan terjadi karena keadaan tertentu, bagian-bagian mesin harus diganti.

### Sikat Utama

1. Tekan klip pelindung sikat ke dalam untuk melepas pelindung sikat, dan keluarkan sikat dari robot.
2. Gunakan alat pembersih yang sesuai untuk membersihkan rambut yang tersangkut di sikat. Kemudian pasang kembali sikat dan tekan pelindung sikat untuk mengunci ke tempatnya.

#### Gbr. E-1

### Sikat Samping

Lepas dan bersihkan sikat samping.

#### Gbr. E-2

### Roda Segala Arah

Gunakan alat pembersih yang sesuai untuk membersihkan rambut yang tersangkut di roda segala arah.

#### Gbr. E-3

### Tangki Air 2-in-1 dengan Kotak Debu

1. Tekan klip pelepas untuk melepas tangki air 2-in-1 dengan kotak debu, lalu kosongkan tangki air.
2. Buka penutup kotak debu, lalu kosongkan kotak debu.
3. Buka penjepit filter untuk mengeluarkan filter HEPA lalu ketuk filter HEPA secara perlahan.

**Catatan:** Jangan bersihkan filter dengan sikat, jari, atau benda tajam untuk mencegah kerusakan.

4. Bilas kotak debu dan filter HEPA dengan air, lalu keringkan alami keduanya sampai benar-benar kering sebelum dipasang kembali.

#### Catatan:

- Jangan membilas bagian luar kotak debu. Jika terdapat noda air, lap hingga kering sebelum memasang kembali.
- Bilas kotak debu dan filter menggunakan air bersih saja. Jangan gunakan detergen apa pun.
- Gunakan kotak debu dan filter saat keduanya benar-benar kering.

#### Gbr. E-4

### Kain Pel

1. Lepaskan rakitan pel dan tarik bantalan pel dari penjepit kain pel.
2. Bersihkan kain pel hanya dengan air, lalu keringkan sepenuhnya sebelum dipasang kembali.

#### Gbr. E-5

### Sensor Robot

Seka sensor robot menggunakan kain lembut dan kering, seperti yang ditunjukkan pada gambar di bawah ini:

1. Laser Sensor Jarak (LDS)
2. Bumper
3. Sensor Kembali ke Dok
4. Sensor Antijatuh

**Catatan:** Kain yang basah dapat merusak elemen sensitif di dalam robot dan dok pengisian daya. Bersihkan menggunakan kain kering.

#### Gbr. E-6

### Kontak Pengisian Daya dan Area Pemancar Sinyal

Bersihkan kontak pengisian daya dan area pemancar sinyal menggunakan kain yang lembut dan kering.

#### Gbr. E-7

### Baterai

Robot menggunakan paket baterai litium-ion berkinerja tinggi. Pastikan baterai terisi daya dengan cukup untuk penggunaan sehari-hari agar kinerja baterai tetap optimal. Jika robot tidak akan digunakan dalam waktu lama, matikan dan simpan. Untuk mencegah kerusakan akibat pelepasan daya berlebih, isi daya robot setidaknya tiga bulan sekali.

## Penyelesaian Masalah

Masalah	Solusi
Robot tidak mengisi daya.	<ul style="list-style-type: none"> <li>Baterai lemah. Isi daya robot di dok pengisian daya, lalu coba lagi.</li> <li>Suhu baterai terlalu rendah atau tinggi. Sebaiknya, gunakan alat ini pada suhu antara 32 °F (0 °C) dan 104 °F (40 °C).</li> </ul>
Robot tidak mengisi daya.	<ul style="list-style-type: none"> <li>Dok pengisian daya tidak terhubung ke sumber listrik. Pastikan kedua ujung adaptor menancap dengan benar.</li> <li>Kontak antara kontak pengisian daya pada dok pengisian daya dan robot kotor. Bersihkan kontak pengisian daya.</li> </ul>
Robot gagal terhubung ke Wi-Fi.	<ul style="list-style-type: none"> <li>Kata sandi jaringan Wi-Fi salah. Pastikan kata sandi yang digunakan untuk terhubung ke jaringan Wi-Fi Anda benar.</li> <li>Robot tidak mendukung koneksi Wi-Fi 5 GHz. Pastikan robot terhubung ke koneksi Wi-Fi 2,4 GHz.</li> <li>Sinyal Wi-Fi lemah. Pastikan robot berada di area dengan cakupan Wi-Fi yang baik.</li> <li>Robot mungkin belum siap untuk dikonfigurasi. Keluar dan masuk kembali ke aplikasi, lalu coba kembali sesuai instruksi.</li> </ul>

Masalah	Solusi
Robot tidak dapat kembali ke dok pengisian daya.	<ul style="list-style-type: none"> <li>Rute kembali untuk mengisi daya terhalang, misalnya pintu tertutup.</li> <li>Dok pengisian daya terputus dari sumber listrik atau dipindahkan saat robot tidak ada di dalamnya. Sambungkan dok pengisian daya ke catu daya atau letakkan robot di dok pengisian daya untuk mengisi daya.</li> <li>Ada terlalu banyak halangan di sekitar dok pengisian daya. Letakkan dok pengisian daya di tempat yang lebih terbuka.</li> <li>Memindahkan robot akan membuat robot memosisikan ulang dirinya sendiri dan akan membuat kembali peta jika proses tersebut gagal. Jika berada terlalu jauh dari dok pengisian daya, robot mungkin tidak bisa kembali secara otomatis, sehingga Anda perlu mengembalikan robot ke dok pengisian daya secara manual.</li> <li>Seka area pemancar sinyal pada dok pengisian daya untuk menghilangkan debu atau serpihan.</li> </ul>
Robot macet di depan dok pengisian daya dan tidak dapat kembali.	<ul style="list-style-type: none"> <li>Periksa apakah ada cukup ruang di kedua sisi atau depan dok pengisian daya agar robot tidak terhalang.</li> <li>Robot mungkin selip jika lantai di depan dok pengisian daya terlalu basah. Jika demikian, keringkan lantai sebelum mencoba kembali.</li> <li>Sebaiknya pindahkan dok pengisian daya ke tempat lain, lalu coba lagi.</li> </ul>

## Penyelesaian Masalah

Masalah	Solusi
Robot tetap menyala.	<ul style="list-style-type: none"> <li>Robot tidak bisa dimatikan saat sedang mengisi daya. Sebaiknya keluarkan robot dari dok pengisian daya, lalu tekan dan tahan tombol daya selama 3 detik untuk memmatikannya.</li> <li>Jika langkah 1 tidak berhasil mematikan robot, tekan dan tahan tombol daya selama 10 detik untuk mematikan robot secara paksa. Jika masih belum berhasil, hubungi layanan purnajual.</li> </ul>
Laju pengisian daya lambat.	<ul style="list-style-type: none"> <li>Saat baterai lemah, pengisian daya robot membutuhkan waktu sekitar 4,5 jam hingga penuh.</li> <li>Jika menggunakan robot pada suhu di luar rentang yang ditentukan, laju pengisian daya akan otomatis melambat guna memperpanjang masa pakai baterai.</li> <li>Kontak pengisian daya pada robot dan dok pengisian daya mungkin kotor, seka dengan kain kering.</li> </ul>
Suara yang dihasilkan robot saat beroperasi makin bising.	<ul style="list-style-type: none"> <li>Periksa apakah filter kotak debu tersumbat. Jika tersumbat, bersihkan atau ganti dengan yang baru.</li> <li>Benda tajam mungkin tersangkut di sikat utama atau kotak debu. Periksa dan singkirkan benda keras yang ada.</li> <li>Sikat utama atau sikat samping mungkin kusut. Periksa dan singkirkan benda asing yang ada.</li> <li>Alihkan mode isap ke Standar atau Senyap.</li> </ul>

Masalah	Solusi
Robot bergerak tanpa mengikuti rute yang telah ditentukan.	<ul style="list-style-type: none"> <li>Benda seperti kabel daya dan sandal harus dirapikan sebelum menggunakan robot.</li> <li>Pengoperasian di permukaan yang basah dan licin menyebabkan selip pada roda utama. Sebaiknya, keringkan area yang basah sebelum menggunakan robot.</li> </ul>
Robot melewatkan ruangan yang seharusnya dibersihkan.	<ul style="list-style-type: none"> <li>Pastikan pintu ruangan yang akan dibersihkan terbuka.</li> <li>Periksa apakah ada ambang pintu ruangan yang lebih tinggi dari 2 cm. Robot tidak dapat memanjat ambang pintu atau anak tangga yang tinggi.</li> <li>Area di depan ruangan yang akan dibersihkan mungkin basah dan licin, sehingga robot selip dan bekerja tidak normal. Coba keringkan lantai sebelum menggunakan robot.</li> </ul>
Robot tidak melanjutkan pembersihan setelah mengisi daya.	<ul style="list-style-type: none"> <li>Pastikan robot tidak sedang dalam mode Jangan Ganggu (DND), yang mana akan mencegah robot melanjutkan pembersihan.</li> <li>Robot tidak akan melanjutkan pembersihan setelah Anda meletakkan robot secara manual ke dok pengisian daya atau mengirim robot untuk mengisi daya melalui aplikasi atau tombol .</li> </ul>
Air tidak keluar dari tangki air atau hanya sedikit yang keluar.	<ul style="list-style-type: none"> <li>Periksa apakah ada air di dalam tangki air.</li> <li>Bersihkan kain pel jika kotor.</li> <li>Pastikan kain pel dan penjepit kain pel dipasang dengan benar sesuai panduan pengguna.</li> </ul>
Robot mengalami masalah.	<ul style="list-style-type: none"> <li>Matikan robot, lalu aktifkan kembali.</li> </ul>

## Penyelesaian Masalah

Masalah	Solusi
Robot tidak lagi membersihkan dengan efisien atau meninggalkan debu.	<ul style="list-style-type: none"><li>• Kotak debu penuh. Bersihkan.</li><li>• Filter tersumbat. Bersihkan.</li><li>• Ada benda asing yang tersangkut di sikat utama. Bersihkan.</li></ul>
Robot tidak melakukan pembersihan terjadwal.	<ul style="list-style-type: none"><li>• Baterai robot hampir habis. Pembersihan terjadwal tidak akan dimulai kecuali baterai robot terisi minimal 15%.</li></ul>

Untuk dukungan lebih lanjut, hubungi kami melalui <https://global.dreametech.com>.

# Spesifikasi

## Robot

Model	RLF41GA
Waktu Pengisian Daya	Sekitar 4,5 jam
Tegangan Terukur	14,4 V $\pm$
Daya Terukur	45 W
Frekuensi Pengoperasian	2400-2483,5 MHz
Daya Output Maksimum	< 20 dBm

Dalam kondisi penggunaan normal, alat ini harus berada dalam jarak minimal 20 cm antara antenna dan badan pengguna.

## Unit Baterai Litium-ion yang Dapat Diisi Daya

Model	C1251A6
Jenis	Li-ion
Jumlah	1
Kapasitas Terukur	2,95 Ah

## Dok pengisian daya

Model	RCFA0301
Input Terukur	20 V $\pm$ 1 A
Output Terukur	20 V $\pm$ 1 A

## Adaptor

Produsen	Shenzhen CHANZEHO Technology Co., Limited
Model	CZH024N200100EUWA1
Input Terukur	100-240 V ~ 50/60 Hz 0,8 A Maks
Output Terukur	20 V $\pm$ 1 A 20 W
Efisiensi Aktif Rata-Rata	85,47%
Efisiensi pada Beban Rendah (10%)	81,30%
Konsumsi Daya Tanpa Beban	< 0,1 W

## Pembuangan dan Pelepasan Baterai

Baterai litium-ion bawaan mengandung unsur yang membahayakan lingkungan. Sebelum membuang baterai, pastikan baterai dilepas oleh teknisi yang memenuhi syarat dan dibuang di fasilitas daur ulang yang sesuai.

- baterai harus dilepaskan dari alat sebelum dibuang;
- alat harus terputus dari sumber listrik saat melepas baterai;
- baterai harus dibuang dengan aman.

### PERHATIAN:

Sebelum melepaskan baterai, putus sambungan listrik dan kosongkan baterai hingga sehabis mungkin.

Baterai yang tidak diperlukan harus dibuang di fasilitas daur ulang yang sesuai.

Jangan buang baterai di tempat bersuhu tinggi untuk mencegah terjadinya ledakan.

Dalam kondisi buruk, baterai dapat mengeluarkan cairan. Jika terjadi kontak, siram dengan air dan dapatkan bantuan medis.

### Panduan Pelepasan:

1. Balik robot, gunakan obeng untuk melepas baut yang ada di belakang robot, lalu buka penutupnya.
2. Cabut terminal antara baterai dengan papan PCB untuk melepas baterai.

## Informasi WEEE



Semua produk dengan simbol ini adalah limbah peralatan listrik dan elektronik (WEEE sesuai arahan 2012/19/EU) yang tidak boleh dicampur dengan sampah rumah tangga yang tidak tersortir. Anda harus melindungi kesehatan manusia dan lingkungan dengan cara menyerahkan limbah peralatan ke titik pengumpulan yang ditugaskan untuk mendaur ulang limbah peralatan listrik dan elektronik, yang ditunjuk oleh pemerintah atau otoritas setempat. Pembuangan dan daur ulang yang tepat akan membantu mencegah potensi konsekuensi negatif terhadap lingkungan dan kesehatan manusia. Hubungi otoritas setempat untuk informasi lebih lanjut tentang lokasi serta syarat dan ketentuan tempat pengumpulan tersebut.

## EN Warranty

1. Dreame is liable to the consumer for any lack of conformity in material or workmanship not detectable at the time of the purchase.
2. Warranty period: please refer to the customer service office for more information. If the territory where the consumer is located has different regulations, local regulations prevail.
3. The warranty will not be applicable in the following cases:
  - a) Issues due to carelessness, use, or installation that does not comply with the instructions provided by Dreame.
  - b) Tampering and/or modifications of the product by entities or individuals not expressly authorized by Dreame.
  - c) Damage due to accidental causes and/or negligence on the part of the consumer, with particular reference to external parts.
  - d) Parts subject to wear that do not have manufacturing defects.
  - e) No valid purchasing document (receipt, invoice, or other) is provided to certify the date the product was purchased.
  - f) The model and/or numbers of the product on the purchase certificate is not consistent with the model and/or numbers shown on the product.
4. Please scan the QR code to get after-sales contact information.
5. The after-sales service (including quality warranty) in diverse regions is solely applicable to the local version of Dreame products. Please contact the after-sales service in the region where your product version originates for support.

## TR Garanti

1. Dreame, satın alım sırasında tespit edilemeyen malzeme ve işçilik kusurlarından tüketiciye karşı sorumludur.
2. Garanti süresi: daha fazla bilgi için lütfen müşteri hizmetleri ile iletişime geçin. Tüketicinin bulunduğu bölgede farklı düzenlemeler olduğu takdirde yerel düzenlemeler geçerlidir.
3. Aşağıdaki durumlarda garanti geçerli değildir:
  - a) Dreame tarafından sağlanan talimatlara uygun olmayan kullanım, kurulum veya dikkatsizlik nedeniyle ortaya çıkan sorunlar.
  - b) Dreame tarafından açıkça yetki verilmemiş kuruluşlar veya kişiler tarafından ürün üzerinde onaysız değişiklikler yapılması ve/veya ürünün modifiye edilmesi.
  - c) Belirli harici parçalar önde olmak üzere, kaza nedenlerinden ve/veya tüketici ihmalkarlığından doğan hasarlar gerçekleştiğinde.
  - d) İmalat kusurlarına sahip olmayıp yıpranmaya tabi olan parçalar.
  - e) Ürünün satın alındığı tarihi belgelemek için hiçbir geçerli satın alma belgesinin (makbuz, fatura ve diğer) sağlanmaması.
  - f) Satın alma belgesi üzerindeki ürün modeli ve/veya numaralarının ürün üzerinde gösterilen model ve/veya numaralarla tutarlı olmaması.
4. Satış sonrası hizmet iletişimi bilgilerine ulaşmak için lütfen QR kodunu taratın.
5. Farklı bölgelerdeki satış sonrası hizmetler (kalite garantisi dâhil) yalnızca Dreame ürünlerinin yerel sürümü için geçerlidir. Destek için lütfen ürün sürümünüzün ilk satın alındığı bölgedeki satış sonrası hizmetler ile iletişime geçin.

## VI Bảo hành

1. Dreame tuyên bố chịu trách nhiệm với khách hàng về vật liệu chưa đạt tiêu chuẩn hoặc lỗi lắp ráp mà không thể phát hiện tại thời điểm mua hàng.
2. Thời hạn bảo hành: vui lòng tham khảo phòng dịch vụ khách hàng để biết thêm chi tiết. Nếu tại quốc gia người tiêu dùng sinh sống có quy định khác, vui lòng ưu tiên áp dụng quy định của quốc gia đó.
3. Không áp dụng bảo hành trong các trường hợp sau:
  - a) Các sự cố do bất cẩn, sử dụng hoặc cài đặt không đúng theo hướng dẫn do Dreame cung cấp.
  - b) Giã mạo và/hoặc sửa đổi sản phẩm bởi các tổ chức hoặc cá nhân không được Dreame ủy quyền rõ ràng.
  - c) Hư hỏng do nguyên nhân ngẫu nhiên và/hoặc sơ suất của người tiêu dùng, đặc biệt liên quan đến các bộ phận bên ngoài.
  - d) Những bộ phận bị mài mòn không do lỗi sản xuất.
  - e) Không cung cấp được chứng từ mua hàng hợp lệ (biên nhận, hóa đơn hoặc chứng từ khác) để xác nhận ngày sản phẩm được mua.
  - f) Mất và/hoặc mã số của sản phẩm trên giấy chứng nhận mua hàng không khớp với mẫu và/hoặc mã số được thể hiện trên sản phẩm.
4. Vui lòng quét mã QR để biết thông tin liên hệ sau bán hàng.
5. Dịch vụ sau bán hàng (bao gồm bảo hành chất lượng) ở các khu vực khác nhau chỉ áp dụng cho phiên bản sản phẩm Dreame tại địa phương. Vui lòng liên hệ với dịch vụ sau bán hàng tại khu vực có phiên bản sản phẩm của bạn để được hỗ trợ.

## TH การรับประกัน

1. Dreame รับผิดชอบต่อผู้บริโภคในกรณีที่วัสดุหรือการผลิตไม่เป็นไปตามมาตรฐานที่ไม่สามารถตรวจพบได้ในขณะซื้อ
2. ระยะเวลาการรับประกัน: โปรดดูข้อมูลเพิ่มเติมที่สำนักงานบริการลูกค้า หากเขตแดนที่ผู้บริโภคตั้งอยู่มีข้อบังคับที่ต่างกัน ให้ถือตามข้อบังคับท้องถิ่น
3. ไม่สามารถใช้การรับประกันได้ในกรณีต่อไปนี้:
  - a) ปัญหาที่เกิดจากความประมาท การใช้งาน หรือการติดตั้งที่ไม่เป็นไปตามคำแนะนำของ Dreame
  - b) การดัดแปลงและ/หรือการแก้ไขผลิตภัณฑ์โดยหน่วยงานหรือบุคคลที่ไม่ได้รับอนุญาตอย่างชัดเจนจาก Dreame
  - c) ความเสียหายอันเกิดจากอุบัติเหตุและ/หรือความประมาทเลินเล่อของผู้บริโภค โดยเฉพาะอย่างยิ่งกับชิ้นส่วนภายนอก
  - d) ชิ้นส่วนที่เกิดการสึกหรอซึ่งไม่ได้บ่งพ่องจากการผลิต
  - e) ไม่มีเอกสารการจัดซื้อที่ถูกต้อง (ใบเสร็จรับเงิน ใบแจ้งหนี้ หรืออื่น ๆ) เพื่อใช้ยืนยันวันที่ซื้อผลิตภัณฑ์
  - f) รุ่นและ/หรือหมายเลขของผลิตภัณฑ์ในใบสั่งซื้อไม่ตรงกับรุ่นและ/หรือหมายเลขที่แสดงบนผลิตภัณฑ์
4. โปรดสแกนคิวอาร์โค้ดเพื่อรับข้อมูลติดต่อหลังการขาย
5. บริการหลังการขาย (รวมถึงการรับประกันคุณภาพ) ในภูมิภาคต่างๆ ใช้ได้เฉพาะกับผลิตภัณฑ์ Dreame เวอร์ชันท้องถิ่นเท่านั้น โปรดติดต่อฝ่ายบริการหลังการขายในภูมิภาคที่คุณซื้อผลิตภัณฑ์รุ่นของคุณเพื่อรับการสนับสนุน

## **ID** Garansi

1. Dreame bertanggung jawab kepada konsumen atas setiap kurangnya kesesuaian pada bahan atau pengerjaan yang tidak terdeteksi pada waktu pembelian.
2. Masa garansi: harap kunjungi kantor layanan pelanggan untuk mendapatkan informasi selengkapnya. Jika di wilayah tempat konsumen tinggal memiliki regulasi yang berbeda, regulasi setempatlah yang berlaku.
3. Garansi tidak akan berlaku pada kasus berikut:
  - a) Bermasalah karena kecerobohan, penggunaan, atau pemasangan yang tidak mematuhi petunjuk yang diberikan oleh Dreame.
  - b) Mengubah dan/atau modifikasi produk oleh entitas atau individu yang secara tidak jelas diizinkan oleh Dreame.
  - c) Kerusakan karena penyebab yang tidak disengaja dan/atau kelalaian yang sebagian disebabkan oleh pelanggan, khususnya pada komponen eksternal.
  - d) Komponen yang dapat aus yang tidak memiliki kecatatan produksi.
  - e) Tidak memiliki dokumen pembelian yang valid (tanda terima, faktur, atau lainnya) untuk mengonfirmasi tanggal pembelian produk.
  - f) Model dan/atau nomor produk pada sertifikat pembelian tidak sama dengan model dan/atau nomor yang tertera di produk.
4. Pindai kode QR untuk memperoleh informasi kontak purnajual.
5. Layanan purnajual (termasuk garansi kualitas) di berbagai wilayah hanya berlaku ke produk Dreame versi lokal. Harap menghubungi layanan purnajual di wilayah tempat versi produk berasal untuk mendapatkan bantuan.

### Contact us



 Website:  
<https://global.dreametech.com>

The word "dreame" is the abbreviation of Dreame Technology Co., Ltd. and its subsidiaries in China. It is the transliteration of the company's Chinese name "追觅", which means striving for excellence in every endeavor and reflects the company's vision of continuous pursuit, exploration and search in technology.



For more support, contact us via <https://global.dreametech.com>

Manufactured by: Dreame Trading (Tianjin) Co., Ltd.

Made in China



EU-A01