

User Manual

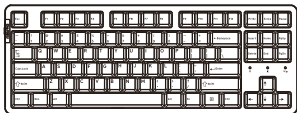

Keyboard x1

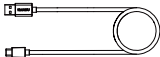

Cable x1



**Keycap/Switch puller
(2 in 1) x1**



User manual x1

Physical specification

Connection: wired+2.4G+BT

Standard: 87keys

Cable length: 1.8 meters

Size: 364*136*41mm

Switch: ≥ 50 millions clicks

Weight: 740 \pm 10g

Electrical specification

Key conflict: N-Key rollover

Light mode: various

Battery: 4000mAh

Macro: support

Supply voltage: 5V

Charging current: 360mA

Power consumption: Wired mode: ≤ 60 mA (no light) ≤ 200 mA (brightest backlight);
2.4G/BT: ≤ 50 mA (no light) ≤ 180 mA (brightest backlight)

Compatibility: Windows XP/Win 7/Win 8/Win 10/Win 11/Mac OS

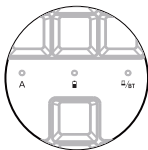

Indicator light:

A : Caps Lock

 : Slow flashing red when battery is low

 : BT and 2.4G switching

How to Connect

Work mode

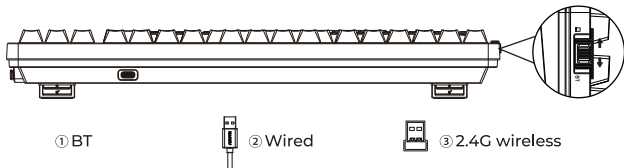

2.4G mode



Pairing: Long press FN+Q for 3sec, and plug in PC

BT mode

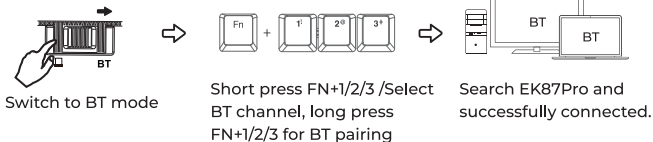

Fn combination keys

 +  = Switch backlight effects  +  = Switch backlight color

 +  = LED brightness +  +  = LED brightness -

 +  = Keyboard light brightness cycle

Multimedia function



Fn+F1 = My computer	Fn+F2 = Home	Fn+F3 = Email
Fn+F4 = Calculator	Fn+F5 = Stop	Fn+F6 = Previous
Fn+F7 = Play/Pause	Fn+F8 = Next	Fn+F9 = Volume-
Fn+F10 = Volume+	Fn+F11 = Mute	Fn+F12 = Win ⌘ MaC OS (3s)
FN+ESC (3s)= Rest	FN+WIN(3s) = Win lock/unlock	

EK87 PRO

Mfgr.: Dongguan Togran Electronics Technology Co., Ltd
Add.: No. 110, Shidan Rd, Shijie Town, Dongguan City,
Guangdong Province, China 523290

Tel.: +86 769 8630 8806 Fax: +86 769 8630 8826
Email: Info@dareu.com CS@dareu.com
Web: www.dareu.com