

产品型号：613007

Drill four corner holes - 1/2" Diameter

FOR TOP MOUNT INSTALLATION

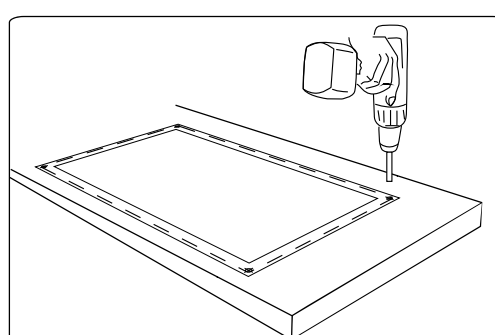

Drill four corner holes - 1/2" Diameter

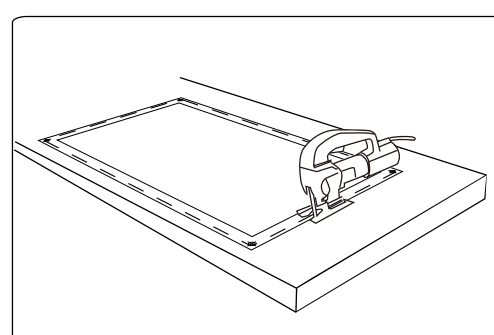

Cut along this dotted line to connect holes

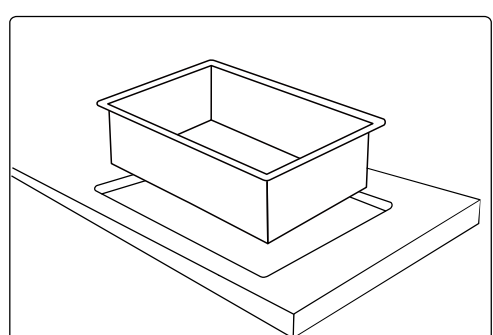

Check hole size

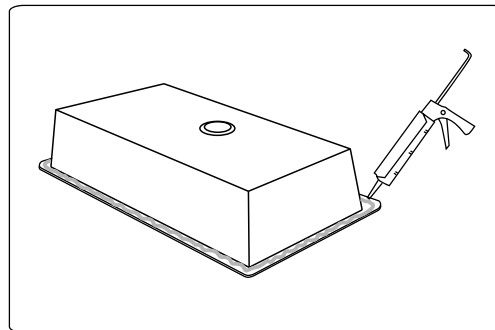

Silicone Sealant

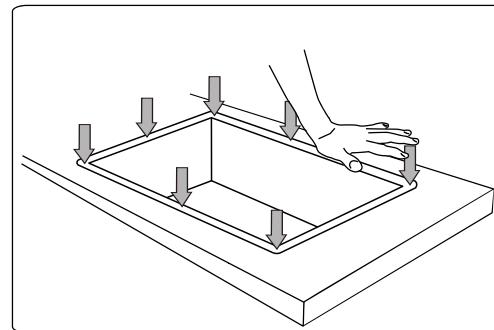

Press

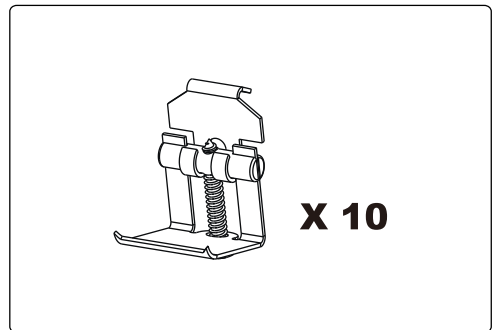

Thread

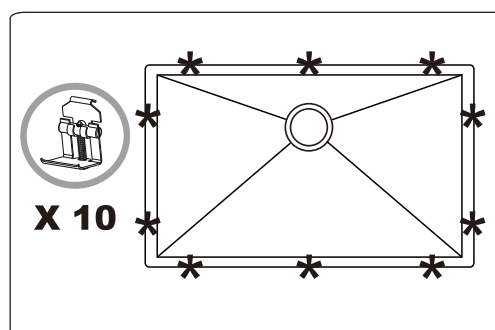

Locate

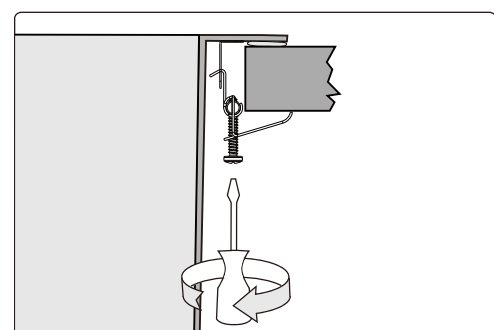

Tighten All

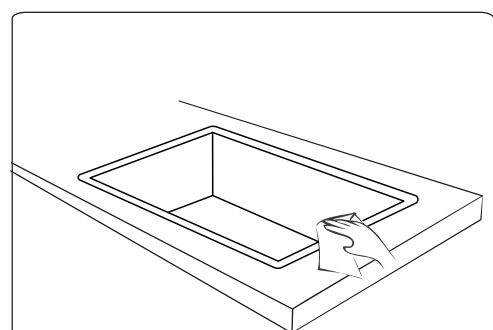

Clean

FOR UNDER-MOUNT INSTALLATION

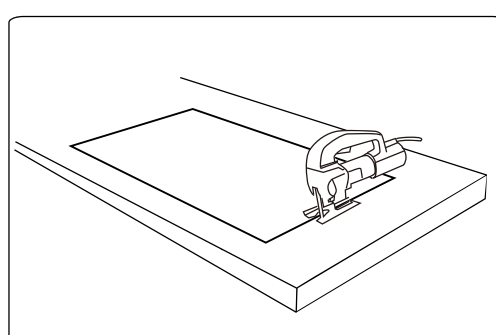

Cut along this line to connect holes

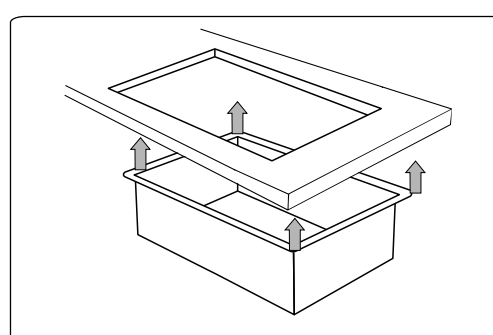

Check hole size

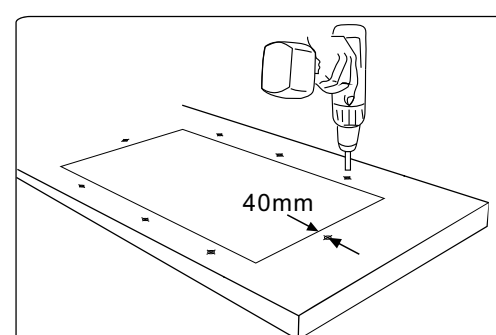

Drill eight holes on the back
φ10 with depth 15mm on the back

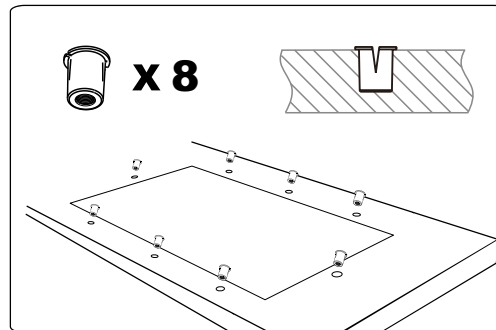

Anchor

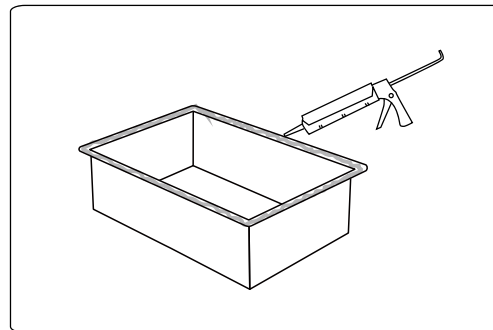

Silicone Sealant

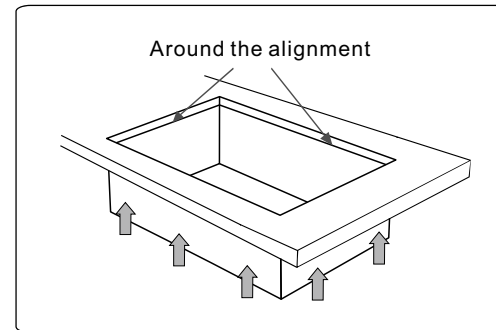

Around the alignment

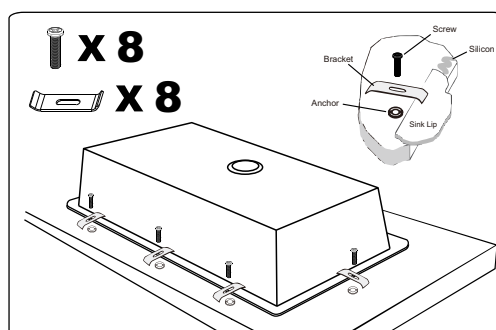

Locate

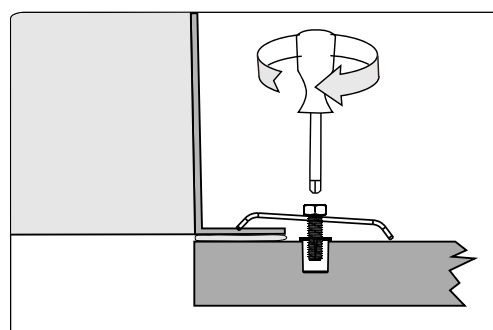

Tighten All

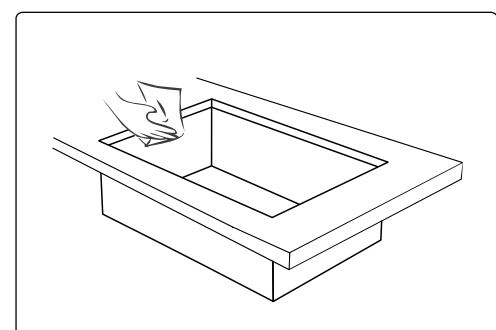

Clean

FOR TOP MOUNT INSTALLATION (854x464mm)

FOR UNDER-MOUNT INSTALLATION (830x440mm)